



Published Monthly

Hard Copy Distribution 400 - Website : 6,000 average/month

Windellama, Oallen, Nerriga, Bungonia, Mayfield, Quialigo, Lake Bathurst, Bungendore & Tarago

## Windellama Brigade AUCTION



Windellama Hall & Grounds

8th April 2017

(Cnr Windellama and Oallen Ford Roads)

DAY STARTS 7.00 AM AUCTION

ITEMS booked in by 9.00 AM AUCTION

COMMENCES 10.00 AM



The Auction is supported by

**GRAEME WELSH REAL ESTATE &**

**NICK HARTON - LIVESTOCK MANAGER BRAIDWOOD -**

**RAY WHITE REAL ESTATE**

- ♦ ITEMS FOR AUCTION may be donated to the Brigade
- ♦ ITEMS sold for more then \$10 will attract a 10% service commission donated to the Brigade
- ♦ ITEMS sold for \$1000 or more will attract a 8% service commission donated to the Brigade
- ♦ ITEMS sold for \$10 or less are donated to the Brigade
- ♦ ITEMS having a reserve price will attract a \$5 booking fee per lot

**\*\* IMPORTANT \*\* - CASH & CHEQUE ONLY**

*Items for auction are requested to be booked in as soon as possible to assist with advertising in the local paper, eg machinery, antiques, vehicles, building materials. No later than 30<sup>th</sup> March*



HOT & COLD REFRESHMENTS - BBQ STALLS  
RAFFLES - BAR SERVICE

### FURTHER INFORMATION

**Rex Hockey 4844 5147 - Lynton Roberts 0427 445 118**

**Ellen Sylvester 4844 5407(stalls).**

With usually over 1,000 people attending. Limited stall sites are available for enquiries contact Ellen 4844 5407.

Dogs **MUST** be kept on a leash & under control at all times.  
**NO ANIMALS/LIVESTOCK**



**\* BURNING OFF? - Permit now required \***

Windellama Hall is your Neighborhood Safer Place

## Coming Events...

**Annual Subscriptions** - please send your details and **\$30** (cheques payable to 'Windellama News') to cover the annual cost of postage.

All cheques please post to:

**The Secretary, PO Box 705, Goulburn. 2580**

\* Unpaid subscriptions will be cancelled after one month

If you have any short articles, anecdotes, or something else interesting about yourself, your family, or the community; please write it down and drop it in our letterbox at the Hall. We will edit it and publish it in the Windellama News.

**A LOCKED POSTAL BOX IS AT THE FRONT OF THE HALL, 3444 OALLEN FORD RD, IN THE STONE WALL FOR THE COLLECTION OF ITEMS FOR PUBLICATION**

**Items left in the box after the deadline will not be collected or included in the News**

Articles, adverts, etc may also be sent by email to:

[newswindellama@gmail.com](mailto:newswindellama@gmail.com)

**Adverts sent by email will not be inserted unless payment is received by the deadline.**

### Our Policy on Receipts

The Windellama News makes out a receipt for all advertising payments made to the paper. We don't post out receipts to save cost and we assume that the appearance of the advertisement in the paper could normally be taken as proof of payment. If you require a posted receipt please include a stamped self-addressed envelope with your payment.

It would be greatly appreciated if anyone sending money to the Windellama News would include their name and address and a note saying what it was for and put it in a sealed envelope. This would avoid a lot of confusion and uncertainty.

### Notice to advertisers, article submitters & readers

The Windellama News is published and authorised by the Windellama Progress Association Inc. Whilst every care has been taken in the production of the News & publishing to the web page on the community website, the editor takes no responsibility for any inaccuracies, errors or omissions. All such contributors by forwarding advertising, notices, & articles, agree to indemnify the publisher & warrant that the material is accurate & neither deceptive nor misleading, in breach of copyright, defamatory or in breach of any other laws & regulations.

The responsibility for advertisements complying with the Trade Practices Act lies with the person, company or agency submitting such for publication. Original material appearing in this newsletter is copyright. It may be reproduced in part or in whole for the benefit of the community, provided that the source of the material is fully acknowledged. If you have any queries about using material from the Windellama News, please contact the editor.

### March

**11 Progress Meeting at 5.00 pm at the Windellama Hall**

**25 Brigade Training and General Meeting**

**26 Nerriga Progress & Sporting Association Meeting at 4.00 pm Nerriga hall**

### April

**8 Fire Brigade Auction**

**29 Landcare—Managing your Land**

## Inside this Issue.....

Community Noticeboard	3
Historical Society	5
Nerriga Page	7
In Your Garden	9
Wires	11
Garden Club	13
SES	15
Windellama Fire Brigade	17
Country Fair Results	18/19/21
Historical—Tom Bryant	23
School	25
Willow Glen Gardeners	27
Tarago Men's Shed	29
Markets	30
Church Information	31
Brigade Auction	32
Classified Ads	33/34
Community Information	35
Calendar	36

**DEADLINE FOR ALL ISSUES IS THE 20TH OF THE PRECEEDING MONTH**

**YOUR WINDELLAMA NEWS IS PRINTED BY BUSINESS REQUISITES, GOULBURN**

# Community Notice Board

## Attacking weeds with moths!

Biological control of gorse, a weed of national significance, is the catalyst for the release of the Gorse Soft Shoot Moth last Friday at Currawang.

Goulburn Mulwaree Council undertook the release in conjunction with the Department of Primary Industry and the Wingecarribee and Queanbeyan-Palerang Councils.

Gorse (*Ulex europaeus*) is a plant that significantly reduces pasture and animal productivity and in forestry plantations, reduces tree establishment and growth. The annual cost of gorse management to agricultural and forest industries in Australia have been estimated at \$7 million.

Scott Martin, Council's Business Manager of Building & Environment, undertook the release with Noxious Weeds Officers last week. "Biological control can be very effective for gorse, which is a harsh weed that is tough to control. Council will be checking the site where the release took place throughout the coming year, and I expect we will see some really good results."

Gorse soft shoot moths are approximately 1cm long with a 2cm wingspan. The early instar larvae will cause some damage to gorse; however the later instar larvae have the greatest impact. Larval feeding can sometimes kill the shoot entirely, however if this fails



the destruction of spines from feeding destroys the plant's reproductive buds thereby reducing or preventing flowering and seed set the following spring.

Biological control is a long-term process that is not expected to eradicate gorse. It is hoped that once all biological control agents become widespread their combined impact will eventually result in a reduction in gorse vigour, seed output and rate of spread. This will in turn make it more susceptible to grazing, weather stresses and herbicides as part of an integrated management program.

## WINDELLAMA LANDCARE GROUP

Do you wish to participate with other members of the Windellama community in both individual and community land care projects?



Are you new to the Windellama area and want support or advice in managing your land, caring for the local environment and wildlife?

An open public Landcare meeting is to be held in April to help us plan our activities and projects for 2017 and inform newcomers about Landcare. David Hilhorst of the Braidwood Local Land services Office will chair the meeting. David is very familiar with the Windellama area.

Come to the meeting and let us know what your Landcare issues and needs are and any suggestions or proposals you may have.

The date for the Landcare MANAGING YOUR LAND (*What are your critical issues?*) day, has just been announced. Mark your diary now for 29<sup>th</sup> APRIL 2017 @ Windellama Hall. 10am till 2.30 [Morning tea and lunch provided, specialist guest speakers, grant info, futureproofing, record your issues, district project info and much, much more!].

More information to come

**The next meeting of the Windellama Progress Association will be on Saturday 11th March 2017 at the Windellama Hall at 5.00 pm.**

**All welcome.**

## Craft @ Windellama Hall

We meet from the second Tuesday of the month 1—4 pm.

For more information please call Irene Turner on 48445 214.



# ACOM DESIGN

PO Box 806,  
Goulburn 2580

Yarralla,  
Oallen Ford Rd  
Bungonia 2580

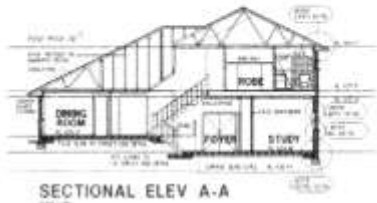

**Robert C Everingham**

*Building Designer & Draftsman*

**New Homes, Alterations & Additions**  
Duplex, Villa, Townhouse Developments  
Rural, Commercial, Industrial Buildings  
Free Quotes - Competitive Rates - Prompt Service  
Energy Efficient (SEDA), Eng Dwgs: Mech, Struct, HVAC

**TEL 4844 4321**

**MOBILE 0417 682 022**

**FAX 4844 4323**

**EMAIL [acomdesign@bigpond.com.au](mailto:acomdesign@bigpond.com.au)**



MEMBER  
STANDARDS AUSTRALIA



MEMBER  
BUILDING  
DESIGNERS  
ASSOCIATION  
OF NEW SOUTH WALES INCORP

## Heard of Wiltipoll Sheep?

The Wiltipoll is a hardy, prime lamb, wool shedding breed developed in Australia



- ✓ Full wool shedding – no costs of shearing
- ✓ Fly lice & grass seed resistant
- ✓ No jetting dipping or mulesing
- ✓ Stays in allocated paddock
- ✓ Superior quality meat sheep
- ✓ Ideal for organic lamb production - consistent multiple births

### Windellama Downs



#### **Stock for Sale**

Commercial or Registered Stud Stock

Mob: 0416 047 488 Ph: 4844 5175

Email: [windellamadowns@inet.net.au](mailto:windellamadowns@inet.net.au)

### **Changes to Waste Management Centre Opening Hours**

Changes to Waste Management Centre opening hours. From Monday 2 May 2016 Goulburn Mulwaree Council's Waste Centres will operate different hours.

**Goulburn** Waste Management Centre open 7 days per week from 8am to 4pm.

**Marulan** Waste Management Centre to be open from 8am to 4pm on Saturday and Sunday, plus 8am to 12noon on Friday and Monday.

**Tarago** Waste Management Centre to be open from 8am to 4pm on Saturday, Sunday and Monday.

**All Waste Management Centres** will be closed on public holidays and from 12 noon on Christmas Eve.

Marulan and Tarago Waste Management Centres will also be closed from 12noon to 12.30pm on opening days to enable the operator a dedicated lunch break.

## yarralaw springs wines

Goulburn & Southern Tablelands Newest Winery

Cellar Door Upcoming Open Days

Hours – 11am to 4:00 pm

Sunday: 5 March

Sunday: 12 March

Sunday: 19 March

~check website for any changes or

call prior for a drop in visit or purchase anytime ~  
25 kms down Windellama Road from Goulburn  
turn left into Muffets Road

email: [admin@yarralawsprings.com.au](mailto:admin@yarralawsprings.com.au)

web: [www.yarralawsprings.com.au](http://www.yarralawsprings.com.au)





*Hello Everyone,*

*We had a great start to the new year with lots of new comers visiting our Museum at the Country Fair and at our last market day.*



*Thank you for positive comments on our Museum and your very kind donations.*

*We will have a busy start to the year, our main focus will be on the completion of the display shed at the back of the museum.*

*Windellama History is preserved in our wonderful museum, with lots to look at and lots to talk about, so come and visit at the next Market Day.*

*We have a selection of history books by local Authors Tom Bryant & Rex Hockey, for sale as well as the ever popular "Wild Windellama" by Carina Clarke.*

*The museum is open on Market Days - every third Sunday of each month, from 9am till 1pm and by arrangement.*

*The Next Meeting will be on Saturday 1st April 2017 10am at the Museum*

***NEW MEMBERS and GUESTS ARE ALWAYS WELCOME***

***For any enquiries please contact: Rex Hockey: 48 445147***

***Marcia Tatam: 48 216421***

***Julian Woods: 48 44 5270***



# Better Barbeques



At Barbeques Galore you'll discover a whole new world of outdoor entertaining.

A lot of places are selling outdoor products, like Barbeques. The difference is WE can show you how to use them!

We've got a huge range of the latest aluminium, wicker and timber settings to suit both the size and style of your backyard.

**4821 1292 or 4821 4889**

388 Auburn Street, Goulburn [www.barbaquasgalora.com.au](http://www.barbaquasgalora.com.au)

**LARGE RANGE  
GREAT PRICES  
FRIENDLY STAFF  
GREAT SERVICE**

**BARBEQUES  
GALORE**

**BBQBaHar.**

# Nerriga Progress & Sporting Association

**Nerriga Progress and Sporting Association's next meeting is on Saturday, March 26 2017. 4.00 pm at Nerriga Hall.**

**All welcome.**

## Nerriga Gardeners

### Nerriga Garden Club

We met at Helen's and had the usual superb morning tea and coffee before heading out to pick blackberries. We picked with secateurs as the bushes will be sprayed soon and any reduction in the seed load is good. The idea then was for the good people to sit and carefully pick off the fruit to make in preserves whereas the lazy ones like me just trimmed off the worst of the twigs and leaves and stuffed the rest in a pot and boiled it up before setting it to drain through muslin for jelly. I have not detected any difference in the product even



when I do take care and it saves getting prickled all the time. My new stupid dog had a good time supervising and finding the last of the water in the small dams so everyone was happy.. We then returned to the house and indulged in a magnificent lunch before wending our ways home. We are all hoping for rain and the last bit while welcome was barely enough to wet the ground but it was good not to get the damaging hail and luckily a bit more fell at Carwoola.

## NERRIGA HALL fees for Hire of Hall and Supper Room

Hall -

Full Day \$200

Half Day \$100

Supper Room - \$60

Supper Room &  
Kitchen \$100

\* GST to be added to all fees

Security/Cleaning Fee \$100

Refundable on inspection

To book please contact

Helen Rolland 02 4845 9115

[helenrolland@bigpond.com](mailto:helenrolland@bigpond.com)

Our next meeting will be at Linda's on Fernleigh Drive of the Nerriga road and we will meet at the entry at 9-45am for an entertaining day on March 16<sup>th</sup>.





# THINKING DAMS? THINK **DIVALL'S**



GET **100%** TAX  
DEDUCTION ON  
YOUR FARM DAM

**RIGHT NOW**



282 CARRICK ROAD, GOULBURN NSW 2580  
PHONE: (02) 4829 8200  
WEBSITE: [WWW.DIVALLS.COM.AU](http://WWW.DIVALLS.COM.AU)





The nights should be cooling down now, and the deciduous tree and shrubs should be changing colour. I hope we get some more rain.

My pumpkins are running with small ones on, but the parrots are eating the green pumpkin. We had to net the vegetables to stop the bird damage.

## VEGETABLES

Plant seedling of cauliflower, cabbage, Brussel sprouts or broccoli, give them a dressing of liquid fertilizer to get them established.

Also plant lettuce, turnips, radish and white onions.



## FLOWERS

Plant seedling of alyssum, pansy, viola, stocks, poppies, calendula, carnation, dianthus, polyanthus, larkspur, snapdragon, static, verbena and Virginian stock.

Plant seed of sweet peas, cornflowers, nemesia, primula, cineraria.

Other seedlings to plant are wallflower, sweet William( tall and dwarf).

Perennial plants such as hollyhock Canterbury bells, aquilegia(columbines), delphiniums and pentstemons can be purchased this month. Before planting give the garden a good dressing of compost and a light dressing of lime (if your garden is acid). You can lift and divide old perennial plants and trim them back and replant them.

Watch for aphids and various caterpillars can appear on roses.

Black aphids on chrysanthemums they can be spray with Malathion. Roses can be spray with complete rose spray. If there are only a few you can quash them or hose them off.

You can fertilizer your lawns this month, it will need a good soaking after or wait until the rain comes.



Propogating cutting of geraniums, fuschia and hydrangeas. A pot 10cm across will take anything up to a dozen cuttings, making sure they are planted around the edge of a terra cotta pot as they will get more warmth. Using a mixture of 1 part coarse sand to 2 parts of peatmoss, have at least 2 eyes in the mixture and 2-3 eyes (buds) out, making sure the mixture never dries out. I cover with clear plastic bag witch help keeps the soil moist





## **MICK'S MULTI TRADES**

ABN: 90 178 544 738

Multi Skilled Tradesman

Windellama NSW

Lic # MVTC 126573

Mob: 0413 059 587

Email: [micksmultitrades@gmail.com](mailto:micksmultitrades@gmail.com)

Proudly supporting the Windellama community is Mick

A multi skilled tradesman and diesel mechanic by trade

We renovate bathrooms, tiling and floating floors.

We can also build your shed and help you design and convert your shed into a home, installing your water tanks and fencing.

I have always looked after the locals, and turn a hand to any job.

**So shoot me an email or phone anytime, you'll be pleasantly surprised at our down to earth rates.**



# **CJ Solar**

"Quality Systems that last"



**Home, Business or Community Organisations**

**Custom Designed To Meet Your Energy Needs**

- ◆ Stand Alone Systems
- ◆ OnGrid With Battery Backup
- ◆ Grid Connect
- ◆ Clean Energy Council Accredited

**Ph: 4849 4225**

**[www.cjsolar.com.au](http://www.cjsolar.com.au)**

PREVIOUSLY TRADING AS SUN POWER

LICENSED ELECTRICAL CONTRACTORS (241654C)





NSW Wildlife Information,  
Rescue & Education Service Inc.

## SOUTHERN TABLELANDS BRANCH

# TO FEED OR NOT TO FEED

By Kay Muddiman – Media Officer

Understandable then that many who wish to encourage birds into their gardens do so by feeding them, however this inadvertently causes the birds harm. Whilst understanding that it is done with the best of intentions, WIRES does not recommend the feeding of any native birds for the following reasons:

- Artificial feeding is not necessary. Native birds do not need extra food as they are well adapted to their environment and will be much healthier and happier overall if left to eat only their normal diet.
- Most birds eat a balanced diet; 90% eat insects and nectar, seed or fruit. People feeding birds the wrong food changes the balance of their diet and can negatively impact their health.
- Feeding birds can increase aggression and stress as many try to feed together - this wouldn't happen naturally.
- Artificial feeding can change the balance of species in the wild as it can increase some species, which in turn, decreases others. The Rainbow lorikeet for example has taken great advantage of the artificial feeding and has all but eliminated the shy Scaly Breasted lorikeet from our urban areas.
- Bird seed left out in damp conditions rots, grows mould and introduces disease to the birds, and can attract rats and mice.
- Feeding encourages birds to become dependent on humans for their survival. They can lose the ability to find food for themselves, this is particularly so if they are juveniles who should be learning to find their natural food
- It can cause sickness and deformities in young as high quantities of salt are present in bread and processed foods.
- Feeding can make them overweight and high quantities of fat are present in processed food and meat. Raw meat is lacking in calcium and has high levels of phosphorous which contribute to dietary imbalance and severe deficiencies.
- Feeding can spread disease through a concentration of food and birds in large numbers in one place. This is particularly so with Psittacine Beak and Feather Disease (PBFD), which is an infectious disease affecting many of the parrot family, such as Sulphur-crested Cockatoos, Corellas, Galahs, Gang-gang Cockatoos, King Parrots and Rosellas and is fatal.



*A galah on our lawn - feeding the way nature intended*

The best way to encourage birds to your garden is by providing plenty of native shrubs and other vegetation where they can not only find their own food, but also shelter, nest and hide from predators. A birdbath will also encourage birds to visit you, and will provide an essential and reliable source of water for them. Birdbaths should be scrubbed clean and refilled daily to avoid the spread of disease such as the PBFD mentioned above, and also should be topped up through the day in times of excessive heat.

Our birds, along with all native animals have had to adapt to our cities, towns, roads and farms. Unfortunately, some are injured or orphaned when they come into contact with our way of life. The increasing pressures of land clearance, domestic and feral animals, pesticides and motor vehicles all take their toll. Within the Southern Tablelands Branch we do as much as we can to care for the injured and/or orphaned creatures of our area that need help, but we are always in need of more volunteers.

## WOULD YOU LIKE TO HELP?

*If so, why not consider becoming a WIRES volunteer?*

The basic skills required are obtained by undertaking a WIRES Rescue & Immediate Care Course. Training is undertaken online, at your own pace – with one face-to-face workshop. **The next Rescue & Immediate Care Workshop will be held in Goulburn on Sunday 26<sup>th</sup> March, 2017 from 9am to 1pm.** If you are interested and would like more information, please ring our branch member Kristen **on 0458 720 470** and have a chat about what is involved in WIRES membership, the Rescue & Immediate Care Course, and the above workshop.

**Should you need advice or help for injured or distressed wildlife please ring our Branch Rescue Number – 4822 3888. Our volunteers will be only too happy to assist.**

Until next time, take care all.

Kay

**JPS AUTO**  
 MVRIA licenced vehicle repairer.  
 Licence number 47196

Mobile Repairs and Servicing to  
 most vehicles.  
 Battery-Breakdown Service

Peter Clinch MIAME  
 63 Cathcart Street  
 Goulburn, NSW, 2580

**0412 424 512**  
**jpsauto@iinet.net.au**



**JPS IT SUPPORT**  
 Computer Repairs

Richard Brodie  
 Manager  
**0404 567 535**

richard@jpsitsupport.com.au  
 www.jpsitsupport.com.au

63 Cathcart Street  
 Goulburn NSW 2580  
 Ph: 02 4873 5220  
 Fax: 02 4855 0153



## Our Advertising Charges

Classifieds - Personal  
 (maximum 2 lines)

**FREE**

	Month	Year11 issues)
Small advertisement (business card size)	\$ 6.50	\$ 65.00
Quarter page advertisement	\$12.00	\$120.00
Half page advertisement	\$25.00	\$250.00
Full page advertisement	\$50.00	\$500.00
Double page discount		\$90.00

Inserts - \$40.00 for 400 inserts into hard copies

Typesetting of adverts: \$50

### **PAYMENT:**

**Cheques: payable to Windellama News**

**PO Box 705, Goulburn. 2580**

**Direct Deposit or EFT: IMB Ltd; BSB 641.800;**

**A/c 200045794 with Name & advert as detail**

**\* Unpaid adverts will be cancelled after one month**

**\* All advertising copy must be accompanied with payment**

All advertising enquiries to

Christine Woodcock

# WINDELLAMA PLAYGROUP

at

Windellama Public School

Each Thursday

9.30am – 11.30am

**BYO snacks - tea & coffee supplied**

**Qualified art teacher visiting each fortnight**

**Bring your bubs & toddlers for a fun morning**

**Music, stories, sand-play, free-play, art, craft.**

# FREE!





It just goes to show how resilient the Windellama Community and surrounding communities are by supporting the Windellama Country Fair during extremely high temperatures leading up to and on the day of the fair on Saturday 11<sup>th</sup> February.

The awning on the Eastern side of the hall was put to good use by the Windellama School Pupils, Teachers, and Helpers on benching day, when sheltering from the extreme heat above 40 degrees Celsius. As soon as the doors were opened for access to the inside of the hall, they were in and setting up their flower arrangements in jars. I was surprised that the water went into the jars and not over themselves to cool down. What a fantastic job the pupils did with the bits and pieces of foliage and flowers provided in making their arrangements. However, their creative ability they utilised in creating the different objects with the fruit and vegetables were extra good. I suppose some credit must go to the teachers and helpers for keeping the children focussed on what they were doing. The picture colouring in items was really good too.

The number of fresh flowers benched in vases and different flower arrangements was amazing and all I can say is “bet their water storage systems are low”. It just goes to show how creative exhibitors are with their displays in the wine and roses, decorative tea pots, and glass reflections. Anyhow, these exhibits were really appreciated by our club and the community.

The potted plants like Ferns, Succulents, Foliage, Bonsai and Flowering plants were also presented well.

Although the produce section lacked numbers, what was benched was good. An initiative by one exhibitor in benching a box of produce that they had grown was well received. In fact this idea was so good we will have an added class to cater for this type of entry at the next country fair.

The cooking section including the children exhibits was good, although I feel the hot temperature probably added more cooking time to the exhibits.

There was a reasonable selection of Jams and Pickles although, numbers were down.

What craft exhibits on display were excellent, with the champion exhibit once again of high standard. The high temperatures and sweaty hands leading up to the fair was probably the cause for low numbers in this section.

The photography section entries were up in numbers with some excellent shots of country life.

The overall Exhibition Winner across all sections for this year was Di Andrews.

Like I predicted the Magic Jester was well received by the Children and some Adults.

The local bush fire brigade turned up with their truck. This truck then became a major attraction especially when demonstrating the operation of the water hose where the littlies and some oldies were under the spray cooling down.

Windellama Public School Parents and Citizens ran the canteen and kept the patronage fed. The ice blocks donated by Johnno went down well.

Our local SES branch was on hand to help out in case of an emergency and also assisted with any odd jobs needing to be done.

The raffle prizes supplied by our sponsors were great e.g. Garden products and herbs from

*(Continued on page 15)*

# PRONIC

AGRI

A mobile service for all your rural living  
mechanical repairs

Service & repair of : -

Tractors  
Self propelled machinery  
Sprayers  
Quad bikes  
Air conditioning  
Ride on mowers  
And all general farm machinery

Contact Mathew Nicholls

Tel : 02 4844 5857 Mob 0417 998 938

e-mail : [proniacagri@yahoo.com](mailto:proniacagri@yahoo.com)

abn 28 228 073 983

a/c licence no: L058811

## Booyong Alpacas

2217 Windellama Rd.

Quialigo. NSW. 2580.

Tel.02 4844 7267.

Mob. 0417 658730.

Web. [www.booyong.com.au](http://www.booyong.com.au)

Like us on Facebook

[www.facebook.com/booyongalpacashop](http://www.facebook.com/booyongalpacashop)

Email: [booyongalpacas@optusnet.com.au](mailto:booyongalpacas@optusnet.com.au)



**Breeding Coloured Huacaya Alpacas**

since 1997 with a current herd of 175 Alpacas

**Alpaca Sales & Stud Services**

**On Farm Alpaca Shop**

selling 100% Booyong Alpaca Products  
& Selected Imported Alpaca Garments.

Call us for advice or to visit the farm & view  
our Alpacas & Shop.

Buying or selling house or land?

## JOHNSON & SENDALL

Incorporating Mullens & Stephen J Lamond

SOLICITORS – CONVEYANCERS

For advice on all your legal requirements

Morris Owen ~ Alison Howarth ~ Tim McGrath ~ Carl Henwood

p: 02 4821 1588 f: 02 4821 9850 e: [info@johnsonandsendall.com.au](mailto:info@johnsonandsendall.com.au)

[www.johnsonandsendall.com.au](http://www.johnsonandsendall.com.au)

13 Montague Street Goulburn 2580



Athletics Coach

Personal Trainer

Marina Wenban

Ph: 0439 029 313

Accredited Athletics Australia,

AT&FCA, Fitness Australia



Bunnings, Food Voucher from Coles, Produce Vouchers from Fife's Stock Feeds, Animal Puzzles from Goulburn Post Office, Food Hamper plus a Fruit and Vegetable Basket. Luck winners were Bonita Armstrong, Belinda King, Neil Andrews 3 prizes, Johnno's Store 3 prizes, and Shirley Cornish. When your lucks in, it's in, for instance, Neil Andrews also won the Zantis Silver Ear Rings donation.

Other donations were plants from GEHL Garden Centre, Windellama Progress Association allowing use of Hall, Commonwealth Bank financial donation, Soap World Voucher, Ladies Pack from Blooms the Chemist in Market Place; Johnno's Shop ice blocks a big hit. We also received \$50.00 from Beryl Kramer and Cecilia Baxter \$10.00. All items donated helped provide finances to cover the expenses of organising and operating costs for the Windellama Country Fair.

Harry Simm

Secretary

Windellama Garden Club Inc.

## Windellama SES First Aid & CFR

We are currently learning how to record all our activities on the electronic side of things, sounds a great idea, but as you know signal strength is not real great out this way. Technology is great for the young ones, not so great for us oldies.

The SES side of our activities has been nil, but the CFR has been quite the opposite. Fortunately there have been no requests for heat related illness.

Two of our members are able to go to an Ambulance related activity at Jindabyne, this will prove to of great benefit to their future with the CFR.

We are fortunate to have an organization that is prepared to put their resources and knowledge forward, so as to enhance the capabilities of the volunteers under their umbrella. One day is spent on discussion relating to previous events, the second day is hands on with simulated incidents.

I would like to go to a different sphere of things, in as much, we as SES members were in a position to help in whatever way we could, the Windellama Garden Club in the setting up of their Country Fair display. This Fair is a very important display of the different type of creativity of whatever field you may wish to have entered for the judges to cast their expert eye over. The Windellama School children were to be congratulated with their different types of displays entered. The School P&C certainly excelled them selves in the Catering dept; best hamberger I have tasted in a long time.

Entertainment was of a high standard, well done to those who organized that side of things.

The day was not very kind to us, but we survived, the RFS was much in demand when they applied a liberal "spray" of water, good thinking folks.

Nobody, other than those actually involved in the setting up that display and the dismantling of same, can imagine the effort that goes in to this.

Well done to all.

Kevin Muffet

Deputy Unit Controller

Windellama SES/CFR

# READY FOR BUSH FIRE SEASON?

## PREPARE YOUR PROPERTY NOW.

Keep your property clear of regrowth and ensure roads and tracks are accessible with the help of **JCF Contracting**.

We have the experience, manpower and equipment to prepare your property for this bush fire season.

**0428 624 966**

Call Jon for a free assessment of your property.

*SERVICING GOULBURN & SURROUNDING AREAS.*





# WINDELLAMA VOLUNTEER RURAL FIRE BRIGADE

## WINDELLAMA RURAL FIRE BRIGADE

Report all Fires 000  
& Emergencies

Brigade enquiries 4844 5359  
UHF 21

Yass - 6226 3100



RFS website [www.rfs.nsw.gov.au](http://www.rfs.nsw.gov.au)

or

Brigade website [www.windellamarfs.com.au](http://www.windellamarfs.com.au)

Captain – Rex Hockey 4844 5147

Snr Deputy – Jim Meehan, 4844 5554

### BUSH FIRE DANGER PERIOD COMMENCES ON 1<sup>ST</sup> NOVEMBER 2016

#### SOUTHERN TABLELANDS ZONE

NSW Rural Fire Service SOUTHERN TABLELANDS ZONE has declared the start to the statutory Bush Fire Danger Period (BFD) as at 1<sup>st</sup> NOVEMBER 2016.

From November 1, any person wishing to light a fire in GOULBURN MULWAREE, UPPER LACHLAN and YASS VALLEY Local Government areas will require a permit.

**During a Total Fire Ban however, no fires may be lit in the open even if you hold a permit.**

**PERMITS REQUIRED From November 1**

**Fines can apply if conditions are not carried out.**

### THINK BEFORE WORKING OUTSIDE DURING THE FIRE SEASON

**Always have water available for quick use**

**Electric fences can cause fires.** When the fire danger rating is very high or above it is recommended that electric fences be turned off. This action will reduce fires accidentally ignited by these fences. Maintenance can be undertaken to remove vegetation by spraying or brush cutting under the fence lines.

#### COMING EVENT - BRIGADE AUCTION 8<sup>th</sup> APRIL 2017

Brigade Auction to be held on the 8th April at the Windellama Hall & Grounds. So now is the time to get together all those unused goods as they could be exactly what someone else is looking for. If you can spare some time to help either with catering, in the office or on the grounds please contact 4844 5359 as much of the setting up and work is done on the day before as well as on the day. **Become involved in your community and be assured your assistance and efforts are greatly appreciated.**



**Notice:** An interim charge of \$20 will be required for auction items such as fridges, air-conditioners and tyres when selling these goods. The \$20 charge will be refunded from the office when these goods have been removed from the grounds. We thank you for your assistance in this matter.

#### Over the Last Month

The Snr Deputy Jim Meehan advised that over the last month on days of extreme weather condition brigade members have been on standby at the fireshed.

#### Training:

If you wish to take part in the Windellama Brigade training or be contacted by email regarding the monthly training details visit the Brigades website and send an online contact form or email [windellamarfsttraining@gmail.com](mailto:windellamarfsttraining@gmail.com). For information on training dates, times and scenarios check the Brigade website or contact the Acting Captain Jim Meehan 4844 5554.

[www.windellamarfs.com.au](http://www.windellamarfs.com.au).

**General Meeting 25<sup>th</sup> March - 6pm**

**General Meeting 22<sup>nd</sup> April- 6pm**

**Training 25<sup>th</sup> March - 1pm**

**Training 22<sup>nd</sup> April - 1pm**

Please take care on our roads and see you at the next training and meeting. All welcome.

# Windellama Country Fair 2017 Results

## Flower Show

### Open Section

1. Arrangement using weathered wood – free expression  
1st. Di Andrews  
2nd. Di Andrews
2. Arrangement in a teapot accompanied by a lid  
1st. Di Andrews  
2nd. H&T Simm
3. Arrangement using Australian Native flowers & foliage – free expression  
1st. Di Andrews  
2nd. Irene Turner
4. Arrangement using glass – free expression  
1st. Irene Turner  
2nd. Di Andrews
5. Arrangement using flowers & fruit – free expression  
1st. Di Andrews  
2nd. Sandy Cox
6. Float Bowl (Flowers must be floating)  
1st. Di Andrews  
2nd. Sandy Cox
7. Wine & Roses – Free expression  
1st. Irene Turner  
2nd. H&T Simm
8. Foliage Arrangement  
1st. Di Andrews  
2nd. –
9. Miniature Garden Adults – Free Expression  
1st. H&T Simm  
2nd. Di Andrews
10. Miniature Garden - Children  
1st. M Andrews  
2nd. D Andrews

### Dried and Artificial

1. Dried Arrangement  
1st. Di Andrews  
2nd. Di Andrews
2. Arrangement using Silk or Artificial Flowers – Free Expression  
1st. Di Andrews  
2nd. Di Andrews
3. Item using silk or artificial flowers – Free Expression  
1st. Di Andrews  
2nd. Di Andrews

## Cut Flowers

1. One red rose – hybrid tea  
1st. B Bowes  
2nd. B Bowes
2. One pink rose – hybrid tea  
1st. B Bowes  
2nd. Irene Turner
3. One yellow rose – hybrid tea  
1st. B Bowes  
2nd. H&T Simm
4. One rose other than red, pink, yellow or white – hybrid tea  
1st. B Bowes  
2nd. B Bowes
5. Any rose in full bloom  
1st. B Bowes  
2nd. B Bowes
6. Any rose in three stages  
1st. Irene Turner  
2nd. Irene Turner
7. One cut rose from any rose not hybrid tea  
1st. Di Andrews
8. One Cut Miniature Rose  
1st. Sandy Cox  
2nd. Di Andrews
9. Any cut flower not mentioned  
1st. Ian O'Donnell  
2nd. Irene Turner

## Plants Growing in Containers

1. Foliage Plant in Container  
1st. S Zyla  
2nd. D Andrews
2. Flowering Plant in Container  
1st. Meredith Grant  
2nd. Meredith Grant
3. Fern Plant in Container  
1st. C Baxter  
2nd. C Baxter
4. Succulent in Container  
1st. H&T Simm  
2nd. Meredith Grant

## Children's Open Section – Infants

1. Arrangement in a jar  
1st. Victoria  
2nd. M Jackson
2. Vegetable and/or fruit figure  
1st. J Glover  
2nd. J Lewis



### **Children's Open Section – Primary**

1. Arrangement in a jar  
1st. S Glover  
2nd. C Nicholas
2. Vegetable and/or fruit figure  
1st. T Roberts  
2nd. S Lentini

### **Fruit and Vegetable Section**

1. 4 eggs  
1st. I O'Donnell  
2nd. H&T Simm
2. 4 stalks of rhubarb  
1st. Meredith Grant
3. 4 tomatoes  
1st. D Kristen  
2nd. I Turner
4. Collection of any 4 stone fruit  
1st. B Bowes  
2nd. D Kristen
5. Collection of any 4 fruit (not stone)  
1st. Irene Turner

### **Flower Show Champion**

**Di Andrews**

## **CRAFT SHOW**

### **Section A – Knitting & Crochet**

1. Any other article knitted or crocheted (not a rug)  
1st. Vickie Cardiff-Kinder  
2nd. Vickie Cardiff-Kinder
2. Child or baby item  
1st. Colleen Cooper
3. Homespun or handwoven article  
1st. Irene Turner  
2nd. Irene Turner

### **Section B – Sewing**

1. Any Embroidered Article  
1st. Vickie Cardiff-Kinder  
2nd. Vickie Cardiff-Kinder
2. Machine Sewn Article  
1st. Vickie Cardiff-Kinder  
2nd. Vickie Cardiff-Kinder
3. Any Machine quilted or patchwork Item  
1st. Meredith Grant

### **Section C – Craft Open**

1. Hand Painted or appliqued article  
1st. Vickie Cardiff-Kinder  
2nd. Vickie Cardiff-Kinder

2. Cross stitch tapestry  
1st. Vickie Cardiff-Kinder
3. Machine or handmade toy/teddy bear or doll  
1st. Irene Turner
4. Dressed teddy (clothing only judged)  
1st. Irene Turner
5. Dressed Doll (Clothing only judged)  
1st. J&V Cardiff-Kinder  
2nd. Irene Turner
6. Any beaded item  
1st. Vickie Cardiff-Kinder (Champion)  
2nd. Vickie Cardiff-Kinder

### **Section D – Craft Open**

1. Craft from Wood or Metal  
1st. Lloyd Turner
2. Art Painting or Drawing – any subject  
1st. Scott Winspear
3. Best Greeting Card  
1st. Irene Turner  
2nd. Irene Turner
4. Any craft not mentioned  
1st. Harry Kristan  
2nd. Malui Tolar

### **Section E – Children Craft**

1. Under 12 & Over 8 – Painting, Drawing or Computer Art  
1st. Peppa Lees  
2nd. Alexia Tolar & Mardi Andrews
2. Under 12 & Over 8 – Any other Item  
1st. Koby Andrews  
2nd. Mardi Andrews
3. Under 5 Years – Painting or Drawing  
1st. Ruby Porter  
2nd. Ruby Porter

### **Craft Show Champion**

**Vickie Cardiff-Kinder**

## **Cooking**

### **Section A**

1. Fruit Cake  
1st. Irene Turner
2. Boiled Fruit Cake  
1st. Di Andrews  
2nd. Irene Turner
3. 6 Patty Cakes  
1st. Meredith Grant  
2nd. Di Andrews

*(Continued on page 21)*

# **WANTED**

**Rural Properties  
To Sell – Large or Small**

**Over 25 Years experience**

**Call Allan, Tony or Greg**

**on 4822 1411**

**LARGE REWARDS**



**Professionals**

**Goulburn**



4. 6 Plain Scones
  - 1st. Meredith Grant
  - 2nd. Di Andrews
5. Apple Pie
  - 1st. Di Andrews
6. 6 Pikelets
  - 1st. Di Andrews
7. Chocolate Cake – No Icing
  - 1st. Meredith Grant
  - 2nd. H&T Simm

### Children's Cooking

#### Under 5 Years

1. Decorated Arrowroot Biscuit
  - 1st. Erika Tolar

#### 12 Years & Under

1. Decorated Arrowroot Biscuit
  - 1st. Mardi Andrews
  - 2nd. Koby Andrews

### Jams and Pickles

#### Section A

1. Plum Jam
  - 1st. Irene Turner
  - 2nd. Christine Feldmanis
2. Two Fruits Jam
  - 1st. Irene Turner
3. Fruit Jelly
  - 1st. Irene Turner
4. Marmalade jam – any flavour
  - 1st. Irene Turner
  - 2nd. Irene Turner
5. Lemon butter (in a 10cm Jar)
  - 1st. Irene Turner

### Cooking Show Champion

**Irene Turner**

#### Section A

1. Plant Study
  - 1st. Meredith Grant
  - 2nd. Jordyn Allan
2. Relic of the past
  - 1st. Lloyd Turner
  - 2nd. Meredith Grant
4. People study
  - 1st. Michael Lees
  - 2nd. Meredith Grant
5. Three prints on one mount (local subject from the Windellama Fire Brigade Area)
  - 1st. Michael Lees
6. Portrait
  - 1st. Margaret Burgoine
  - 2nd. Michael Lees
7. Landscape
  - 1st. Meredith Grant
  - 2nd. Meredith Grant
8. Animal
  - 1st. Meredith Grant
  - 2nd. Meredith Grant
9. Most Humorous Photo
  - 1st. Shelley Andrews
  - 2nd. Di Andrews
10. Country Life
  - 1st. Sally Lees
  - 2nd. Di Andrews

#### Section B – Children 16 years & Under

1. Any subject
  - 1st. Jordyn Allan
  - 2nd. Jordyn Allan

### Photography Show Champion

**Michael Lees**

### Overall Show Champion (Given to the highest point scorer on the day)

**Di Andrews**

# ~~The Loaded Dog Hotel~~

Tarago EST 1848



Hoteliers: Nicole & Mark Ryan [www.loadeddoghotel.com](http://www.loadeddoghotel.com) 02 4849 4499

1 Wallace Street TARAGO NSW 2580 | 02 4849 4499 | [loadeddoghotelarago@gmail.com](mailto:loadeddoghotelarago@gmail.com)

## LIVE MUSIC @ THE DOG

March 18th

**Paul Grier**  
(Simply Bushed)

April 22nd

**Allan Caswell**

### Social Darts

7:30pm

every Wednesday  
fortnight

come alone or  
bring a team.



### Bingo @ The Dog

11am on 1st

Wednesday of  
each month.

Supporting the  
Tarago Mens Shed



## The Dog Bistro is open 7 days for lunch and dinner

**Sunday to Wednesday 6pm - 8:30pm**

**Thursdays (Nicole's Fish'n'chips) 6pm - 8pm**

**Friday and Saturday 6pm - 8:30pm**

**Lunches 7 days 12noon - 2pm**



Up until the 1890s the Bronte/Glenoval area was known as Mullengullenga or Mullengullengong. Over those years there were several hotels in the area, The Little Couple (1838), Case is Altered (1839-40), Half Way House (1849-1857), Povey's Pub and Dalton's. These were most likely the one hotel with a succession of names.

BUSHRANGING (Goulburn Herald 2 June 1849 p5)

On Thursday night last, four armed men having their faces partly disguised with white crape, visited the Inn kept by Mr J Taylor, of Mullengullengong. Having bailed up the inmates, six in number, the ruffians proceeded to strip Mrs Taylor in the hope of finding some money upon her. They were not disappointed, as there were seven pounds in her pocket, besides some silver. This they took, and after a vain search for more they decamped. Great expectations are entertained that the thieves will be brought to justice, as the police have succeeded in tracking them a considerable distance, and are still hot in pursuit.

MULLENGULLENGA (Goulburn Herald and Chronicle 25 September 1869 p 3)

This comparatively unknown locality is situated midway between Tarago and Windellama, and is occupied by a group of free-selectors, whose children, until recently, have been growing up utterly destitute of any means of education. Through the exertions of the Rev. R Earl, a provisional school has been established, which is carried on in an unoccupied hut kindly lent for the purpose by Mr A Boreham.

The school is placed under the charge of Mr Matthew Montgomery; and we congratulate the settlers in having obtained the services of so worthy a teacher. Efforts are being made for the erection of a stone building to answer the double purpose of a schoolroom and church; and on Wednesday, the 22nd inst., a bazaar and bazaar auction were held in a pad-dock adjoining the present school-room for the purpose of raising funds.

The weather proved remarkably fine; and at nine a.m. visitors began to arrive from Windellama, Bronti, Tarago, Inverloch, Springfield, Collector, and other places, and by eleven a.m. nearly two hundred, people were assembled. The business part of the proceedings then commenced; and at two p.m. the company sat down to a substantial repast, tables being provided by Mesdames Borham, Goodchild, Carey, Gore, Strang, Miller, and Wood. The company were by this time quite ready for knives and forks, and vigorously commenced operations.

Various games occupied the greater part of the afternoon; and as one of the visitors did not forget his violin, the amusements were wound up with a country dance on the green sward, which, together with other sports, forcibly reminds us of "an English merry making in the olden time." The pecuniary results of the whole affair were very satisfactory, the amount realized being nearly £20.

\*\*\*\*\*

POST OFFICE (Goulburn Evening Penny Post 26 July 1881 p2)

General Post Office, Sydney, July 22nd, 1881.

Sir,-I am directed by the Postmaster General to inform you that the letter dated fifteenth instant, from Mr A Boreham, Mullengullenga, presented by you upon the subject of the establishment of a post-office at Mullengullenga is under consideration, and that a further communication respecting it will be addressed to you as soon as a decision has been arrived at in the matter.

I have the honour to be, sir, Your most obedient servant,  
S W. Lambton, Secretary.

(Tom Bryant 8 August 2016)



Department of Public Instruction,  
Sydney, 25th May 1881.

**Tenders for Erection of New Buildings**

**TENDERS** are invited for the **ERECTION** of **NEW PUBLIC SCHOOL BUILDINGS** at **MULLENGULLENGA**.

Plans and specifications may be seen and forms of tender obtained at the office of the Department of Public Instruction, Sydney, and at Mullengullenga, on application to the teacher.

Tenders, endorsed "Tender for Erection of New Buildings, Mullengullenga Public School," must be lodged with the Under-secretary, Department of Public Instruction, at or before ten o'clock a.m. on **WEDNESDAY, 15th June 1881**.

The minister does not bind himself to accept the lowest or any tender.

6961 **JOHN ROBERTSON.**

Goulburn Herald 31 May 1881 p3.



# Countrywide Shower Screens



## Shower Screens

• Frameless • Semi-framed • Framed

## Mirrors

• Bevelled • Polished

**Mick Greenwood**  
**0448 494 220**

Fax: (02) 4849 4220

E: [countrywideshowerscreens@bigpond.com](mailto:countrywideshowerscreens@bigpond.com)

**Free Measure and Quote**

# Lowline Cattle

A small beefy, Angus derived breed – quite & easy to handle.

## Why Lowlines?

### MORE BEEF TO THE HECTARE

- ✓ smaller size means easier handling ✓ higher stocking rates
- ✓ low birth-weights ✓ early maturity ✓ compact bodies
- ✓ excellent feed efficiency ✓ less stress on fencing ✓ less soil compaction



Great for first time cattle owners of any age and gender

## Windellama Downs

*Producing quality, Australian breed cattle & sheep  
suitable for any size rural holding*

## Stock for sale

Commercial or registered stud stock

Mob: 0416 047 488 Ph: 4844 5175

Email: [windellamadowns@iinet.net.au](mailto:windellamadowns@iinet.net.au)

# RON WENBAN

## \*\* LOCAL ELECTRICIAN

\*\*

Rural \* Domestic \* Commercial

**PH: 0428 445 259**

Email: [ronwenban@skymesh.com.au](mailto:ronwenban@skymesh.com.au)

NSW LIC. #174303C

ACT LIC. #2008568



## Southern Districts Piano Service

Pianos • Pianolas • Tuning • Repairs  
Re-polishing • Removals

*Graham Price*

**02 4844 5329**

**Industrial • Commercial • Rural • Domestic**  
**Ph 4844 7088 INSTALLATIONS 0418 234 289**

# ALLARD

**ELECTRICAL CONTRACTING SERVICES**  
**SOLAR UTILITIES & ENERGY SERVICES**  
**GAS-OIL COMBUSTION SERVICES**

[stevenallard@bigpond.com](mailto:stevenallard@bigpond.com)

## ELECTRICAL LICENCES:

NSW Lic.No 198855C

NSW Lic.No 498875S

ACT Lic.No 2009576

QLD Lic.No C13290

## ACCREDITATIONS

AUS C.E.C. Design & Install Grid Connect  
& Stand Alone Solar Systems #A3632173



# Windellama Public School News

**Email:** [windellama-p.school@det.nsw.edu.au](mailto:windellama-p.school@det.nsw.edu.au)  
**Website:** [www.windellama-p.schools.nsw.edu.au](http://www.windellama-p.schools.nsw.edu.au)

**Phone:** 4844 5130  
**Fax:** 4844 5265

## TABLELANDS RURAL EDUCATION COMMUNITY (TREC) SWIMMING CARNIVAL

A big congratulations to Windellama Public School students who attended our annual swimming carnival with fellow TREC schools. We would like to congratulate Tyler and Montana who received champion medals and will go on to represent TREC at the District Swimming Carnival.



## FLOWER, ART AND CRAFT SHOW

The students always enjoy going to the Windellama Hall to work on their entries for the Art, Craft and Flower Show. Thank you to Farmer Felds for donating fruit and vegetables for the figurines. Also thank you to the Garden Club for your dedication and continued support of our school. Congratulations to the awardees.



## ASSEMBLY

We had our first assembly for the year and students enjoyed presenting their work and performing in a play. Congratulations to all awardees. It was nice to see so many parents and grandparents attend.



## COMING UP

- Athletics Carnival
- Year 6 Grip Leadership
- Cross Country

# Nirvalley Homestead Nursery

Growing plants for the Southern  
Tablelands

**4849 4481** *OPEN 7 DAYS*

M 0419 257 663 E [nirvalley@optusnet.com.au](mailto:nirvalley@optusnet.com.au)

**629 Cullulla Rd, Tarago**

GROWERS AND SUPPLIERS OF



- Native and exotic shrubs
- Fruit trees and berries
- Ornamental and Advanced trees
- Windbreak and hedging plants
- Rare and unusual plants
- Tube stock and farm trees
- Contract growing / Special orders
- Plant advice & local delivery

## SUPER SPECIAL Ornamental Trees \$15

(Oaks, maples, beech, birch, elm, Chinese pistachio, gleditsia, liquidambar & more)

Good sized **NATIVES** in  
landscape pots only \$4

Range of **CALLISTEMONS** \$6  
(140mm pot - cream, red, pink, dk pink)

New lot of **CITRUS** just arrived

Talk to us about **LANDSCAPING**  
**Garden Design & Maintenance**  
**IRRIGATION SYSTEMS**  
*Installation & Repairs*



## TARAGO PRE-SCHOOL

Ph. 4849 4427

[tarago.preschool@gmail.com](mailto:tarago.preschool@gmail.com)



Open 5 days a week

Monday - Friday Children 18  
months - 6 years Standard Rate  
- \$25/day Casual and Half days  
available Subsidised rates on  
application



Our staff are Diploma & Cert III qualified



We follow the curriculum  
set out by the

Early Years Learning  
Framework

Preschools NSW  
Education for Life



# Willow Glen Gardeners

<http://www.whispersfromwillowglen.blogspot.com>



On Tuesday the 7<sup>th</sup> of February, The Willow Glen Gardeners headed across the border into Canberra for a field trip to The Australian National Botanic Gardens. The overcast day brought a welcome reprieve from the recent heatwave and made for perfect conditions to stroll around some of the 35 hectare gardens. Everyone gathered in the visitor's centre to collect maps while they patiently waited for the late comers to finally arrive (sorry guys, traffic was terrible!) Of course the first and most important thing on the agenda was finding a place to have morning tea, the onsite

café "Floresco in The Gardens" did not disappoint offering a variety of yummy meals, cakes and very good coffee. They even had tables large enough to fit the entire gang!

The Botanic Garden Showcases a wide variety of native plants (over 6000 species) from all over Australia and offers guided tours as well as a variety of self-guided walking trails. There are themed garden zones such as the "Red Centre Garden" "Rainforest" and "Sydney Region Flora". The gardens are open 7 days and entry is free but there is a cost of \$3.20 per hour for parking.

We had our usual meeting over lattes and slices discussing our gardens. Weeds are of course a 'forever' issue, we discovered the group has an abundance of apples and Warren shared a great tip about putting paper bags over bunches of grapes to help them ripen more evenly, just be sure to cut the bottom corner to allow for drainage.

We headed off for our walk and couldn't help but admire the large and beautifully made sculpture of a 'Thorny Devil' lizard residing in the 'Red Centre Garden'; he made for a great photo opportunity sitting there surrounded by red sand and desert plant life with Black

Mountain and the tower a stunning contrasting backdrop.

An abundance of real wildlife also makes the gardens their home. We took turns spotting and photographing the well camouflaged water dragons that congregated around the rock garden waterfall. Eastern Spine Bills drank nectar from tiny flowering orchids, Fairy Wrens darted amongst the banksias and even a random ginger coloured rabbit was spotted hopping about the Eucalypt lawn.

We stopped for a quick chat to a member of their hard working staff who was in the process of mowing the vast eucalypt lawn - with a push style Lawn mower. She assured us that they did in



# Rusty Balls

- . Natural bush soaps
- . Pet shampoo
- . Anti-bug balls - natural insect repellent
- . Blind Baking Balls
- . Hand made ceramics

Gary & Denise Johnson

**4844 5087**

**sales@rustyballs.com**

**www.rustyballs.com**

## Rainfall Stats



15 June to 15 July

**Rosewood**, Windellama Road, Windellama

37 / 6 days

**Gar-Den**, Oallen Ford Rd, Oallen

48.5 ml / 15 days

**Johnno's Store**, Oallen Ford Rd, Bungonia

/ days

**Tarkierelea**, Fernleigh Close, Windellama

ml / days

**The W's**, Readers Road, Quialigo

ml days

**Corang Cottage**, Braidwood Road Nerriga

49.2 ml / 12 days

**Tarago Village**

ml / days

**Nerrimunga Creek Rd**, Windellama

ml/ days

**Willy Weather**

ml / days

**A1**

**SEPTIC TANK  
&  
GREASE TRAP  
CLEANING SERVICES**



**0408 483 943**

Bob Baird Goulburn

**PH: 4822 3290**

7 DAYS—SERVICING ALL AREAS

## BUSINESS REQUISITES

### Sales & Service

- Photo Copiers
- Fax Machine
- Cash Registers
- Computers
- Stationery
- Consumables

Ph: **4821 5109**

E: [bus\\_req@ozemail.com.au](mailto:bus_req@ozemail.com.au)

**10 Russell Lane, Goulburn**



# Willow Glen Gardeners

<http://www.whispersfromwillowglen.blogspot.com>



fact usually use a ride on but it was out for repairs and she was just glad that it wasn't 40C that day!

Slowly we made our way back out to the car park through the beautiful winding stone paths and boardwalks of the Rainforest Gully, the towering tree ferns above us creating a cool, leafy contrast to some of the dry harsh landscapes you find in other parts of the garden.

We said our goodbyes and I drove away that day feeling very peaceful, Australia really is a beautiful country with such amazing

and diverse native flora; we are lucky to live here!

Our next meeting will be held on Tuesday 7<sup>th</sup> March 2017 at 'Kentgrove' in Goulburn, more information will be sent to members closer to the date. Interested in joining us? Newcomers are always welcome! Please feel free to email [willowglengardenclub@gmail.com](mailto:willowglengardenclub@gmail.com) if you have any questions.

## Tarago Men's Shed 2017

A Tarago Men's Shed General meeting was held at the Hall on Sunday 5 February 2017 attended by 14 members. The main outcomes of the meeting are summarised below:

- a. We now have an ABN and the bank account is almost opened with Bendigo Bank.
- b. We have approval from the Show Society to use the Pavilion as a temporary Men's Shed until we are able to establish a more permanent facility hopefully behind the Hall.
- c. We will have an opening day at the Show Grounds at 10am on Sunday 26 March 2017 followed by a sausage sizzle at about 1230 pm. Come along and help with the setup and become a member.
- d. We have donations of tools and equipment from the Queanbeyan Men's Shed and the Hook family (Helena's dad Syd Pitman) to get us going.
- e. Over \$2000 has been raised to date which includes donations from the 2016 Show, Bingo, the Loaded Dog Esky raffle and a TSA raffle night.
- f. Australian Men's Shed Association membership has been approved.
- g. Financing options are being investigated through AMSA, local State Member Pru Goward, Goulburn Mulwaree Trust and other sources.
- h. Case Sneyers assisted by Richard Kirkwood agreed to investigate additional equipment requirements for shed startup.
- i. There are currently 18 financial members with at least a further four expected.

The next meeting will be a Committee meeting at the 'Dog' on Monday 20 March 2017 at 7:00 pm and then opening of the Men's Shed at the Show Grounds on 26 March 2017.

Keith Hunter

48494256

[krtbhunter@gmail.com](mailto:krtbhunter@gmail.com)



# WINDELLAMA HALL COUNTRY MARKETS

Sunday 19th March

9am to 1pm



Homemade Jams & Preserves  
Pre loved toys & tools  
Locally produced honey  
Lots for the sewing enthusiast  
Hand made baby treasures  
Wooden Nick Nacks & Toys  
Rawleigh Healthcare  
Scented candles  
Hand made knitted goods  
Fresh fruit & vegies  
Alpaca goods

Food and refreshments

New stallholders welcome

Enquiries *Grahame Woodcock* 4844 7275

*Lloyd Turner* 4844 5214

Plenty of parking  
Museum open



## CHURCH INFO

### Catholic Church Services

Parish Priest: Fr. Dermot McDermott  
Assistant: Fr. Assin  
Deacon: Chris Van Gessel

Presbytery & Parish Office  
Phone 4821 1022

\*\*\*\*\*

Sunday Mass will be at 8am on the 2nd & 4th  
Sunday at St. Patrick's **Marulan**.

Mass Times in **Goulburn** are:

Saturday Vigil Mass:

5pm at St. Peter & St. Paul's

Sunday: 7am. at Our Lady of Fatima,  
Nth. Goulburn

Sunday: 10am. at St. Peter & St. Paul's

---

### **St. Joseph's Church, Tarago**

Enquiries: 4821 1022



### CHURCH SERVICES

#### **St Bartholomew's Windellama**

All Services now at St. Barts

12th March

26th March

Services now start at 10.30 am

Reverend Peter Bertram

### **Fees for Hire of Hall or Supper Room at Windellama Hall**

<b>*HALL ALL DAY</b>	\$200
<b>DAY 4hrs or less</b>	\$100
<b>EVENING/NIGHT**</b>	\$200

\*Includes Supper Room & Kitchen

\*\* \$2 per hour for heating

#### **SUPPER ROOM (Includes Kitchen)**

**ALL DAY** \$80

**DAY 4hrs or less** \$40

**EVENING/ NIGHT** \$100

# Use of the premises prior to your booked  
function will incur a surcharge of  
Supper Room Fee

**To Book please ring W. P. A. Secretary,  
Christine Woodcock on 4844 7275**

---

### **St. Andrews (Anglican) - Tarago**

2nd Sunday 9am

St. John's - Lake Bathurst

4th Sunday 9am

---

### **NERRIGA**

#### **ANGLICAN CHURCH SERVICES**

**Held at Nerriga Church**

**2nd Sunday each month at 2pm**

**(Except Easter & Christmas)**

**All Welcome**

# Windellama Brigade Auction



Windellama Hall & Grounds  
8th April 2017

(Cnr Windellama and Oallen Ford Roads)

DAY STARTS 7.00 AM AUCTION

ITEMS booked in by 9.00 AM AUCTION

COMMENCES 10.00 AM



The Auction is supported by  
**GRAEME WELSH REAL ESTATE &  
NICK HARTON - LIVESTOCK MANAGER BRAIDWOOD -  
RAY WHITE REAL ESTATE**

- ♦ ITEMS FOR AUCTION may be donated to the Brigade
- ♦ ITEMS sold for more then \$10 will attract a 10% service commission donated to the Brigade
- ♦ ITEMS sold for \$1000 or more will attract a 8% service commission donated to the Brigade
- ♦ ITEMS sold for \$10 or less are donated to the Brigade
- ♦ ITEMS having a reserve price will attract a \$5 booking fee per lot

**\*\* IMPORTANT \*\* - CASH & CHEQUE ONLY**

*Items for auction are requested to be booked in as soon as possible to assist with advertising in the local paper, eg machinery, antiques, vehicles, building materials. No later than 30<sup>th</sup> March*



HOT & COLD REFRESHMENTS - BBQ STALLS  
RAFFLES - BAR SERVICE

## FURTHER INFORMATION

**Rex Hockey 4844 5147 - Lynton Roberts 0427 445 118  
Ellen Sylvester 4844 5407(stalls).**

With usually over 1,000 people attending. Limited stall sites are available for enquiries contact Ellen 4844 5407.

Dogs **MUST** be kept on a leash & under control at all times.  
**NO ANIMALS/LIVESTOCK**





# Classified Advertisements

**All personal classifieds are FREE & also included in the Tarago Times**  
**We run your advert until you let us know when you have sold it or gained it**

## GENERAL FOR SALE

### English Greener 12 gauge shotgun -

Genuine antique - Double barrel, double hammers, in excellent condition with carry case. Permit/licence needed - \$1200 o.n.o. Phone after 6P.M. 48459147

**Wooden T.V. Console** in vey good condition. Size W= 186cm, H= 147cm, D= 59cm.

Contains 2 glass cabinets, 2 drawers, DVD area + T.V. area. \$250 ONO

**Fowlers Vacola Glass Containers** 13x500ml, 77x750ml, 5x1250ml. Some lids.\$100 the lot. 48445244

**Simpson 5.5kg top load washing machine** in good working order.\$100 ono. Grahame 0403499068

**High grade quality woollen yarn rugs** cream and deep red both matching in great condition small 150 x 239 large rug 250 x 350. \$400 ono. Call Elisha 0403542471

**Teak entertainment unit**, with two glass door display. 6x4 foot. \$75.00 ONO.

**Double bunks**, Metal, with ladder, new innerspring mattresses. \$125 ONO

**Two wooden bed side tables** with cane draws.\$50 for two. Ph. 4849 4480

1 x **King Single bed** \$200; 1 x **Single bed** \$150; 1 x **Single bed** \$100; **Dressing table/ chest of drawers** (8) \$150; 1 x **Glass TV table** \$150; 1 x **Glass coffee table** \$50 Ph 0411 421 416

**Lounges** - 1x3, 1x2 + ottoman - yellow fabric, Matching chair in navy blue. All GC. Offers over \$500 considered. 4849 4222

**Desk** - large timber , 2xdraws/storage under. Leather inlay + matching 2drawers file cab. Ergo office chair. All VGC. \$400 ONO 4849 4222

**Firewood.** \$150 per load. Ph 4849 4520 for delivery

**Firewood.** 2 tonne truck load \$430, ½ truck load \$250. Ph 0401 241 646

**2nd hand container** for sale. \$3000 not/neg. In Goulburn area. Buyer responsible for all transport costs.0435798941

## ANIMAL RELATED FOR SALE

**Parrot Cage** on stand, good cond. \$150 ONO.

Ph 0429 006 745

**Saddles**, good condition, \$350 & \$200. ONO. Riding helmets \$30 and \$20. Also other gear: bridles, leather straps, etc. Ph 0434 286311.

**Miniature Shetland Gig** well balanced, hardly used, some harness, pneumatic tyres, lightweight \$730 ono Ph 62301774 or 0417749064

## ANIMALS FOR SALE

**Alpacas** - lots of different colours & ages.

From \$250 each Phone Jacki 0428 298 157

**Quarriors** (cockatiels) - \$8 each  
Ph 4845 9147 after 6pm

**Horse part Arabian**, 3 yrs old, regd, 14.2 hh, chestnut mare. \$3,000 Ph 0429 461 490

**Alpaca Wethers** Variety of Colours, ages 12 months – 3 years.Halter Trained Wethered, Needled & Shorn. \$400.00 each. Phone 4844 7267. Faye & Keith. Quialigo.

**15 milking goats.** A mixture of male and female. Friendly and well behaved. Price negotiable depending on number purchased. Ring Julia 42761489.

**One six month old pig** for sale - approx. cost \$150. Please call Julia on 4276 1489

## AGISTMENT

**Horse Agistment** available at 41 Burrabinga Road Tarago. Please phone 0429 461 490 for enquires

## CARS, BIKES, TRAILERS, etc. FOR SALE

**1994 Ford Laser Hatch** In good condition Registered to 15th September 2017 Just had major LOG BOOK SERVICE Goulburn Mazda \$ 3,500.00Phone Noel 48445407

**20 inch 7 spoke mag wheels** in great condition near new tyres 95% tread on them. Ideal for Commodores. \$800 ONO call Richard on 0403542471

**2006 Yamaha XT 250.** VG condition, never dropped. 26,000 km. Elderly owner. New battery, unregistered. \$1800 48445244

**1994 Ford Laser Hatch** reg till 15 Sept 2017, good condition 105,000 klms, just had log book service \$3,500 ph 4844 5407.

**Camper Trailer** Queen sized bed with large room. Plenty storage room. Comes with zipon

## Classified Advertisements cont

canopy/shelter. Easy to erect/store/transport.  
\$3500 ono Ph 62301774 or 0417749064

### RURAL RELATED FOR SALE

**Free standing drill press** single phase power and adjustable speed. Comes with vice \$300 ono call Richard 0403542471

**Lucerne Hay** Prime soft green small bales \$15 8 x 3 x 3 bales of lucerne or beardless wheaten available phone 0428493194

**Stanbury Electrical 75 amp battery charger** - new condition, used twice only for Solar batteries - \$1200. Pho 48459147 after 6P.M.

**Gallagher Lightning Diverter** for electric fence energiser protection. New & unused - \$30 Ph: 4844 5843

### WANTED

**Knitting wool** for volunteer knitters for charity. Any leftover wool, any ply, gratefully accepted. Ph Denise 4844 5087

**Instantaneous LPG** Gas Hot Water system 16-20 litres per minute flow rate, working or not. Ph Gary or Sharon on 4844 5980

**Galvanized** farm gates 2 of 3.6 meters wide Galvanized C purlins 100mm / 150mm or 200mm 3metrs to 6 meters long ph Gary or Sharon 4844 5980

**VT Commodore 1997**—2000 5 litre V8 any condition running or not ph Michael on 0413146140

**Horse agistment** for mini mare from November to May to avoid coastal itch. Please call Tanya 4456 5589

### SERVICES

#### Belinda's pet minding

Why stress your pets out by putting them in Kennels or boarding and saving on having to get them vaccinated to put them in boarding.

I will come to you . Leaving your animals in their own homes. I have Vet Nurse experience of 10yrs .

I have a miniature pony stud and also breed and show guinea pigs. I will feed Horses , Dogs, Cats, Goats, Sheep, Chickens Ducks,. Medicate animals daily if needed .

Servicing Windellama , Bungonia, Quialigo and Goulburn.

Contact Belinda on 48447168 or 0497179799

#### Cleaning

Spring is here, need your home spring cleaned, decluttering your home or just want to organise things but just don't have the time. Call Tracey for

## TARAGO TRANSFER & DRUM MUSTER STATION

Open Friday to Monday 8.00am - 4.45pm

Card required for household waste, or fees apply.

Free recycling of: Plastics, tins, batteries, glass, paper & cardboard.

Free recycling of Drum Muster Chemical Drums if they are empty, triple washed and have lids removed.

Paint and Oil cans CAN NO LONGER be dumped regularly. A muster will be held for these.

### Tipping Fees for Tarago

#### Sorted Waste - Domestic Residence Only

Car, station wagon, small ute or small trailer	\$ 22.00
Medium trailer, large ute or 1-tonne truck load	\$ 25.00
Large trailer load	\$ 35.00

#### Unsorted Waste and Non-Residents Waste

Garbage and trade waste (uncompacted, per cubic metre)	\$ 85.00
Garbage and trade waste (compacted, per cubic metre)	\$140.00
Other unsorted waste - 2 x sorted rate per category	

Hard fill demolition waste not accepted at Tarago

**Animals - Note:** Animal carcasses cannot be dumped at Tarago as there are no facilities for burial - please refer to Gouburn Mulwaree Council for availability.

Fridges and Air conditioners	\$ 20.00
Car Bodies	\$ 65.00
Tyres - Car & Motorcycle Tyres (each)	\$ 12.00
Truck tyres (each)	\$ 28.00
Tractor tyres (each)	\$100.00

cleaning services on 48445935 or 0407508060

### LAND FOR SALE

35.5 acres bush block, 3 bedroom house, out buildings, Creek and dam, Oallen Ford Rd Windellama. Please call 0427 5560 69

# COMMUNITY INFORMATION

## Windellama Progress Association

Gary Lourigan (President) 4844 5545  
Christine Woodcock (Secretary) 4844 7275

## Windellama Rural Fire Brigade

Rex Hockey (Captain) 4844 5147  
Jim Meehan (President) 4844 5554  
Ellen Sylvester (Secretary) 4844 5407

## Windellama Field Day Committee

Co-ordinator Grahame Woodcock 4844 7275  
Secretary Leanne Lourigan 4844 5545

## Windellama News

Christine Woodcock (Secretary) 4844 7275  
Ros Woods (Editor) 4844 5155  
Gayle Stanton (Editor) 4844 5156

## Windellama Garden Cub Inc.

Harry Simm (Secretary) 4844 7061  
Sharon King (Treasurer) 4844 5980  
Kevin Muffet (President) 4844 7143

## Windellama Hall Country Markets

Grahame Woodcock 4844 7275  
Lloyd Turner 4844 5214

## Windellama Historical Society

Rex Hockey (President) 4844 5147  
Julian Woods (Secretary) 4844 5270

## Windellama Landcare

Kevin Stewart (President) 0439471714  
Graham Kinder (Secretary) 0429892154  
Jade Kinder (Assistant Secretary) 0449713585

## Windellama CFR

Kevin Muffet 4844 7143

## Windellama School P&C

Shelly Andrews (President) 4844 5630

## Willow Glen Gardeners

Warren Yates 4844 5350

## Wires (wildlife rescue)

Southern Tablelands WIRES 4822 3888

## Justice of the Peace

Linda Shannon 0490041167  
Geoff Burns 4849 4330

## Nerriga PSA

Helen Rolland (President) 4845 9115

## FOR ALL EMERGENCIES eg. FIRES / ACCIDENTS PHONE 000

For Mobile users & Landlines



## Important Phone Numbers

### Rural Fire Brigades



Windellama	Rex Hockey	4844 5147
Tarago 393	Warren Seymour	0419 665
Taylors Creek	Dave Elward	4849 4240
Mt Fairy/Boro	Brett Daniel	0429964079
Bungonia	Terry Lewis	0408 223 380
Gundary	Tony Kent	0437298200
Nerriga	John Rolfe	4845 9160

Bushfire Information 1800 NSW RFS  
or 1800 679 737

[www.windellamarfs.com.au](http://www.windellamarfs.com.au) or [www.rfs.nsw.gov.au](http://www.rfs.nsw.gov.au)

**WINDELLAMA PH: 4844 5359 or  
CHANNEL 21/209 Base**



### AMBULANCE 000

Ambulance Booking 13 12 33  
Goulburn Ambo Station 4827 0444

### Windellama SES 132 500

Kevin Muffet 4844 7143  
Poison Info. Service 13 11 26  
Goulburn Base Hospital 4827 3111

### Police

Tarago Station -  
Snr. Constable Gary Handseker 4849 4411  
Goulburn 4824 0799

### Other

Goulburn Railway Station 4828 5816  
Train info & bookings 13 22 32  
[www.countrylink.info](http://www.countrylink.info)  
Country Energy - interruptions 13 20 80  
Lifeline 13 11 14  
Kids Helpline 1800 551 800



# March 2017

**Mon**

**Tue**

**Wed**

**Thu**

**Fri**

**Sat**

**Sun**

		1	2	3	4	5
6	7	8	9	10	11 Progress Meeting 5.00 pm	12 St Bart's Service
13	14 Craft Afternoon	15	16	17	18	19 Markets
20	21 Craft Afternoon	22	23	24	25 Brigade Meeting & Training	26 St Bart's Service NP&SA Meeting
27	28 Craft Afternoon	29	30	31		