



Editorial & Layout: Gayle Stanton & Ros Woods  
Sec/Treas: Ray Plant

[www.windellama.com.au](http://www.windellama.com.au)

Published Monthly      Hard Copy Distribution 400 - Website : 6,000 average/month  
Windellama, Oallen, Nerriga, Bungonia, Mayfield, Quialigo, Lake Bathurst, Bungendore & Tarago

## WINDELLAMA PROGRESS ASSOCIATION

### ANNUAL GENERAL MEETING

11.00 AM 9<sup>th</sup> July 2017  
at

Windellama Hall

### ALL WELCOME!!

The association needs your advice and your ideas to enhance and progress the community as a whole.

Remember, only you can make a difference! So come along and participate in a friendly, free thinking environment.

*School House 1880*

\* BURNING OFF? - now permitted under regulations  
Windellama Hall is your Neighborhood Safer Place

**Annual Subscriptions** - please send your details and **\$30** (cheques payable to 'Windellama News') to cover the annual cost of postage.

All cheques please post to:

**The Secretary, PO Box 705, Goulburn. 2580**

\* Unpaid subscriptions will be cancelled after one month

If you have any short articles, anecdotes, or something else interesting about yourself, your family, or the community; please write it down and drop it in our letterbox at the Hall. We will edit it and publish it in the Windellama News.

**A LOCKED POSTAL BOX IS AT THE FRONT OF THE HALL, 3444 OALLEN FORD RD, IN THE STONE WALL FOR THE COLLECTION OF ITEMS FOR PUBLICATION**

**Items left in the box after the deadline will not be collected or included in the News**

Articles, adverts, etc may also be sent by email to:

[newswindellama@gmail.com](mailto:newswindellama@gmail.com)

**Adverts sent by email will not be inserted unless payment is received by the deadline.**

## Our Policy on Receipts

The Windellama News makes out a receipt for all advertising payments made to the paper. We don't post out receipts to save cost and we assume that the appearance of the advertisement in the paper could normally be taken as proof of payment. If you require a posted receipt please include a stamped self-addressed envelope with your payment.

It would be greatly appreciated if anyone sending money to the Windellama News would include their name and address and a note saying what it was for and put it in a sealed envelope. This would avoid a lot of confusion and uncertainty .

## Notice to advertisers, article submitters & readers

The Windellama News is published and authorised by the Windellama Progress Association Inc. Whilst every care has been taken in the production of the News & publishing to the web page on the community website, the editor takes no responsibility for any inaccuracies, errors or omissions. All such contributors by forwarding advertising, notices, & articles, agree to indemnify the publisher & warrant that the material is accurate & neither deceptive nor misleading, in breach of copyright, defamatory or in breach of any other laws & regulations.

The responsibility for advertisements complying with the Trade Practices Act lies with the person, company or agency submitting such for publication. Original material appearing in this newsletter is copyright. It may be reproduced in part or in whole for the benefit of the community, provided that the source of the material is fully acknowledged. If you have any queries about using material from the Windellama News, please contact the editor.

## Coming Events...

### July

**9 Progress Annual General Meeting 11.00**

**16 NPSA Meeting 3 pm at Nerriga Hall**

**24 RFS Meeting & Training**

### August

**12 Cake Auction**

**19 Landcare Working Bee**

## Inside this Issue.....

Community Noticeboard	3
Little Athletics	5
Nerriga Page	7
In Your Garden	9
SES	11
Windellama Garden Club	13
School	15
Windellama Fire Brigade	17/19
Labdcare	21
Historical—Tom Bryant	23
Wires	25
Historical	27
Big Read Bus Timetable	28
Nerriga Gardeners	29
Church Information	31
Markets	32
Classified Ads	33/34
Community Information	35
Calendar	36

**DEADLINE FOR ALL ISSUES IS THE 20TH OF THE PRECEEDING MONTH**

**YOUR WINDELLAMA NEWS IS PRINTED BY BUSINESS REQUISITES, GOULBURN**

# Community Notice Board

## Vale

Andrew Ivon McMillan "Andy". Passed peacefully 11th June after a courageous battle. Sadly missed by all his true friends in the Windellama community.

"We are but three people:

Those which we think we are,

Those which others think we are, and

Those which we really are."

RIP Andy.

## Local Little Athletics Group

An expression of interest.

Are there any Parents/caregivers/ community members who would be interested in forming a Little Athletics club for our area?

The formation of a local Little Athletics Group relies heavily on Parents volunteering. The new season commences in October 2017, but maybe if it doesn't get off the ground we can look into the 2018 season if there is enough interest.

If you are interested in starting a Little Athletics group in our local community let Marina Wenban know at [ronwenban@skymesh.com.au](mailto:ronwenban@skymesh.com.au)

For more information about Little Athletics,

## Handyman/Cleaner Wanted.

Immediate Start. Windellama Area. \$\$\$  
Four Hours per week (flexible), for a wide variety of property maintenance jobs from lawns & gardening, fencing maintenance, housecleaning, painting, firewood cutting, to general handyman repairs etc. This long-term position could suit a retired person or similar, who has a range of proven handyman skills. Please send a brief note with your background and contact details to [kingslance@bigpond.com](mailto:kingslance@bigpond.com).

## Market In Tarago

The next Market In Tarago is being held **Saturday 29 JULY.**

**Pop in and support your regional stall holders.**

**Refurbishment of the hall will be complete. Catering in the community run Tarago Country Kitchen, will be for July the Tarago P & C Association.**

**There will be the coffee van, music and the usual stalls in the general area, the Food Walk Way and the 2nd Hand Row - there will be some return stalls and some new.**

**Saturday 29 JULY, 9am - 2pm at the Tarago Town Hall.**

## Farewell

We are saying goodbye to Grahame and Christine Woodcock who are leaving Quailago to start their next adventure in Tasmania.

Christine was not only the Secretary/Treasurer for the Windellama News, but also the Secretary of the Progress Association.

Grahame was on the Progress Association committee, part of the monthly market team, and was one half of the dynamic duo who made our annual Small Farms Field Day such a success.

We wish them all the best for their new adventure and we will greatly miss them and their contribution to the community

**The Annual General Meeting of the Windellama Progress Association will be on Sunday 9th July 2017 at the Windellama Hall at 11.00 am. Come along and have your say. All welcome.**



# Nirvalley Homestead NURSERY



629 Cullulla Rd, Tarago

PH 4849 4481



E. nirvalley@optusnet.com.au

M 0419 257 663



- Big range of natives and shrubs
- Conifers, Hedging, Windbreak
  - Paddock & Feature trees
- Advanced Trees • Tube stock
- Fruit Trees, Nuts & Berries

Our plants are locally grown & suitable for local conditions

## FRUIT TREES & Ornamental trees

*Our bare root trees have arrived*

We have over 120 varieties of fruit trees, nuts, berries and citrus, and a huge range of ornamental trees

*Just call or email for a complete list*

### Windbreak & Shelter Trees

Great looking Leylandii Leighton's Green, Castlewellan Gold & native tubes in stock at Best Prices

Talk to us about **LANDSCAPING**  
**Garden Design & Maintenance**  
and **IRRIGATION SYSTEMS**



## TARAGO PRE-SCHOOL

Ph. 4849 4427

[tarago.preschool@gmail.com](mailto:tarago.preschool@gmail.com)



Open 5 days a week

Monday - Friday

Children 18 months - 6 years

Standard Rate - \$25/day

Casual and Half days available

Subsidised rates on application



Our staff are Diploma & Cert III qualified



# About Little Athletics

Little Athletics is the primary provider of modified track & field events for children between 6-17. We are a volunteer based, community orientated organisation committed to developing children of all abilities by promoting positive attitudes and a healthy lifestyle through family and community involvement in athletics activities. The Association's philosophy is best captured by our motto's: "**Family Fun & Fitness**" and "**Be Your Best**".

**Family** The cornerstone of Little Athletics is extensive family involvement, both in the conduct of weekly activities and in the various administrative tasks connected with the running of all levels of the organisation.

Parents are engaged in the various activities at the local centre level through to state and national levels.

This active parent support of their children reinforces family relationships.

**Fun** With its focus on parent participation and personal improvement, Little Athletics encourages children to enjoy sporting activity. The opportunity for developing important physical coordination and social interaction skills occurs in a supportive and friendly environment.

**Fitness** The emphasis on developing a healthy attitude to physical fitness at an early age is the key to developing good habits in life.

A wide range of age-appropriate running, jumping, throwing and walking events are conducted at Little

Athletics Centres. Children compete with others of similar age, with an emphasis placed on participation and personal improvement, rather than winning.

Little Athletics contributes to the development of foundation skills in running, jumping and throwing that will stand children in good stead throughout their life and at the same time emphasises family values and enjoyment through personal improvement and participation.

Our sport provides skill enhancement at the heart of all other sports and has provided many of our athletes with development to assist them with reaching the pinnacle in their respective sports: Such people as: Sally Pearson - Gary Ablett Jnr - Kimberly Mickle - Simon Black - Steve Hooker - John Worsfold - Geoff Ogilvy - Alisa Camplin - George Gregan - Chris Judd - Dr Peter Larkins - Mike Whitney - Melinda Gainsford - Taylor - Patrick Mills - Jane Flemming and many more



# *Rusty Balls*

- . Natural bush soaps
- . Pet shampoo
- . Anti-bug balls - natural insect repellent
- . Blind Baking Balls
- . Hand made ceramics

Gary & Denise Johnson

**4844 5087**

**sales@rustyballs.com**

**www.rustyballs.com**

## Rainfall Stats

15 May to 15 June



<b>Rosewood</b> , Windellama Road, Windellama	7 ml / 1 days
<b>Gar-Den</b> , Oallen Ford Rd, Oallen	/ days
<b>Johnno's Store</b> , Oallen Ford Rd, Bungonia	ml / days
<b>Tarkierelea</b> , Fernleigh Close, Windellama	ml / days
<b>Corang Cottage</b> , Braidwood Road Nerriga days	71.25ml / 13
<b>Tarago Village</b>	ml / days
<b>Nerrimunga Creek Rd</b> , Windellama	ml / days
<b>Willy Weather</b>	ml / days

**A1**

**SEPTIC TANK  
&  
GREASE TRAP  
CLEANING SERVICES**



**0408 483 943**

Bob Baird Goulburn

**PH: 4822 3290**

7 DAYS—SERVICING ALL AREAS

## BUSINESS REQUISITES *Sales & Service*

- Photo Copiers
- Fax Machine
- Cash Registers
- Computers
- Stationery
- Consumables

Ph: **4821 5109**

E: **bus\_req@ozemail.com.au**

**10 Russell Lane, Goulburn**

# Nerriga Progress & Sporting Association



Queen's Birthday long weekend was another successful Cake Stall and Sausage Sizzle for the Nerriga Progress & Sporting Association.

A chilly start to the day, shoppers came early and we were sold out by 1pm when the sun was shining and the day was a good deal warmer. Thanks to everyone who shopped, baked, and generally helped out.

We were thrilled to have three generations of the Temple family - Betty Temple our Cake Stall stalwart, her daughter Sandra South who helped with cooking and on the Cafe, and her daughter Alison Stutchbury who had her own cake stall showing her artisan baking and decorating for her company, A Sweet Creation.



There was someone who sadly left a cake from A Sweet Creation, at the cafe; and if they would like to speak to one of the NPSA members when we have our October long weekend cake stall and sausage sizzle, we

## NERRIGA HALL fees for Hire of Hall and Supper Room

Hall -

Full Day \$200

Half Day \$100

Supper Room - \$60

Supper Room &

Kitchen \$100

\* GST to be added to all fees

Security/Cleaning Fee \$100

Refundable on inspection

To book please contact

Helen Rolland 02 4845 9115

[helenrolland@bigpond.com](mailto:helenrolland@bigpond.com)

would be happy to reimburse them for missing out.

Our next meeting is Sunday July 16 at 3pm. Please add this to your diary.



# WINDELLAMA HALL COUNTRY MARKETS

Sunday 18th July

9am to 1pm



Homemade Jams & Preserves

Pre loved toys, books & tools

Locally produced honey

Lots for the sewing enthusiast

Hand made baby treasures

Locally grown plants

Rawleigh Healthcare

Scented candles

Hand made knitted goods

**Jox 'n Sox**

Alpaca clothing



Food and refreshments

Enquiries

*Lloyd Turner* 4844 5214

Plenty of parking

Museum open







Roses and fruit trees can be planted now. Also deciduous flowering shrubs and trees, make sure you give them some old compost dug into the soil before planting and water them in well. Roses and fruit trees would benefit from a handful of lime around the ground when planting.

Roses and fruit pruning can start this month, wait for a still day with no breeze and also spray with Lime Sulfur. I like to wait to the first week in August to do my pruning.



Vegetables to sow now are Broad beans, peas and all varieties of onions. Also plant rhubarb, strawberries and asparagus crowns

## FLOWERS

Seedlings for sowing:- Stock, viola, primula wallflower, russel lupins, delphiniums, foxglove, poppies, sweet William and calendula, alyssum, snapdragons, verbena, dianthus. Sow Virginian stock seeds directly into the soil where they are to grow.

Transplant roses and small deciduous trees and shrubs that are in the wrong place.



Take hardwood cuttings of deciduous plants such as oakleaf hydrangea, rose, fig and wisteria.

Cover frost-tender plants on cold nights but remember to remove covers in the morning.

Spray lime sulfur on deciduous plants such as apples, stone fruit, grapevines and roses to control mites, scale, powdery mildew.

Trim wisteria vines, cutting all the side-shoots back to two or three buds.

Keep an eye on bindii in lawns, and dig up or spray before they mature.

You can prune your stone fruit trees in February to give them a good tidy up and take out broken or cross over branches.

## Craft @ Windellama Hall

We meet from the second Tuesday of the month 1—4 pm.

For more information please call Irene Turner on 48445 214.

# **RFH AUTO REMOVALS** *All Areas*

**CARS • TRUCKS  
MACHINERY • ETC..  
• REMOVED FREE**



**CALL RON ANYTIME!**

**0411 115 977**



## **WANTED**

Artists to be part of the new &  
Art Exhibition at the  
Marulan Memorial Hall.

The exhibition will run for a full  
year with the exhibiting artists  
changing every 3 MONTHS.

There is a small entry fee &  
commission on each sale

Interested artists should contact  
Jill Wall on 0408 421 199 or

Email:

[themarulanartexhibition@gmail.com](mailto:themarulanartexhibition@gmail.com)

(a not for profit community project)



## Windellama SES First Aid & CFR

The Windellama Unit played host to Goulburn Region members and also to Goulburn Local SES Unit this evening , 19th, for the presentation of Long Service Medals, special award Medal and Citation Medals for members of the Local Windellama Team, their names were as follows: Noel Sylvester, Margaret Burgoine, Graham Kinder and Kevin Muffet. The Citation Medals came as a result of the services rendered by the local SES/ CFR members who attended the Defence Force Bus rollover on the Sandy Point Road in November of 2015.

Two other members of the Windellama SES were awarded 5 Year Long Service Medals, they were John Zyla and Soie Policarprio.

The Goulburn Mayor, Bob Kirk was a special guest for the presentation of the medals. He in fact had the pleasure of presenting these medals.

We are just about through an Urban Search and Rescue course at the moment.

There was not a great demand on the services of our CFR unit since I last communicated with you.

It is with regret that I have to report that one of our Members, Andrew Mc Millan died just recently.

Kevin Muffet  
Deputy Unit Controller  
Windellama SES.

**Make the right call  
to get the right health care**  
*at night, on weekends and public holidays*

**1** Your Doctor or nearest general practice for after hours options  
Details available at [nhsd.com.au](http://nhsd.com.au)

**2** Medical advice or support  
Call the after hours GP helpline on **1800 022 222**

**OR** **Emergency**  
Call **000** in a medical emergency or visit your nearest Emergency Department for a serious illness or injury.

[coordinate.org.au](http://coordinate.org.au)



# ACOM DESIGN

PO Box 806,  
Goulburn 2580

Yarralla,  
Oallen Ford Rd  
Bungonia 2580

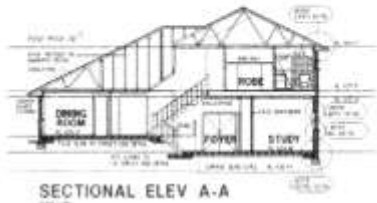

**Robert C Everingham**

*Building Designer & Draftsman*

**New Homes, Alterations & Additions**  
Duplex, Villa, Townhouse Developments  
Rural, Commercial, Industrial Buildings  
Free Quotes - Competitive Rates - Prompt Service  
Energy Efficient (SEDA), Eng Dwgs: Mech, Struct, HVAC

**TEL 4844 4321**

**MOBILE 0417 682 022**

**FAX 4844 4323**

**EMAIL [acomdesign@bigpond.com.au](mailto:acomdesign@bigpond.com.au)**



MEMBER  
STANDARDS AUSTRALIA



MEMBER  
BUILDING  
DESIGNERS  
ASSOCIATION  
OF NEW SOUTH WALES INCORP

## Heard of Wiltipoll Sheep?

The Wiltipoll is a hardy, prime lamb, wool shedding breed developed in Australia



- ✓ Full wool shedding – no costs of shearing
- ✓ Fly lice & grass seed resistant
- ✓ No jetting dipping or mulesing
- ✓ Stays in allocated paddock
- ✓ Superior quality meat sheep
- ✓ Ideal for organic lamb production - consistent multiple births

### Windellama Downs



#### **Stock for Sale**

Commercial or Registered Stud Stock

Mob: 0416 047 488 Ph: 4844 5175

Email: [windellamadowns@inet.net.au](mailto:windellamadowns@inet.net.au)

### **Changes to Waste Management Centre Opening Hours**

Changes to Waste Management Centre opening hours. From Monday 2 May 2016 Goulburn Mulwaree Council's Waste Centres will operate different hours.

**Goulburn** Waste Management Centre open 7 days per week from 8am to 4pm.

**Marulan** Waste Management Centre to be open from 8am to 4pm on Saturday and Sunday, plus 8am to 12noon on Friday and Monday.

**Tarago** Waste Management Centre to be open from 8am to 4pm on Saturday, Sunday and Monday.

**All Waste Management Centres** will be closed on public holidays and from 12 noon on Christmas Eve.

Marulan and Tarago Waste Management Centres will also be closed from 12noon to 12.30pm on opening days to enable the operator a dedicated lunch break.

## yarralaw springs wines

Goulburn & Southern Tablelands Newest Winery  
Cellar Door Upcoming Open Days

Hours – 11am to 4:00 pm

Sunday: 2nd July

Sunday: 9th July

Sunday: 16h July

~check website for any changes or

call prior for a drop in visit or purchase anytime ~  
25 kms down Windellama Road from Goulburn  
turn left into Muffets Road

email: [admin@yarralawsprings.com.au](mailto:admin@yarralawsprings.com.au)

web: [www.yarralawsprings.com.au](http://www.yarralawsprings.com.au)



## Windellama Garden Club Incorporated News

On Saturday 10th June three of our club members attended the Windellama School Auction. This event was well organised with excellent items for auction. The school is very fortunate to have very good sponsors and it goes without saying that these sponsors need to be supported by the community. I only wish my pocket was deeper. The food on offer was once again excellent (yummy) especially the cakes.

Our club and friends on Thursday the 15th June visited the Price property at 1080 Cullulla Road Mayfield where we viewed their collection of many different items. This collection re-kindled memories of my childhood years. We also had the opportunity to purchase different items.

At our last meeting held at Sandy and Johnno's place on the 20<sup>th</sup> June we discussed our Can-Assist fund raiser via our cake auction to be held on Saturday 12<sup>th</sup> August 2017. This year for our Cake Auction we will need the community support with donations of cakes, pies, scones etc. for the cake auction and also, if anyone can lend a hand or two it will be greatly appreciated.

Gary Lourigan was also in attendance and asked how the Progress Association can assist with the running of the Country Fair.

After the meeting Sandy showed us her handiwork and garden. Her greenhouse has been modified by her and inside plenty of cuttings and plants have been potted-up.

Our next meeting will be on Tuesday 4<sup>th</sup> July at St Bartholomew's Church on Windellama Road where with Willow Glen Gardeners we will give the garden and surrounds a clean-up.

In our garden the onions and leeks are in and standing up like soldiers and the broad beans are starting to poke though. The frosts encountered have separated the ripe pumpkins from their leaves. The brassicas are a little slow in growth but I have another bed ready which I will put some more seedlings in. The Rose garden has been weeded and we can now see the Tulips and Daffodils poking their greenery up. Once again the common call at our place is "more rain please".

Finally, a Cheerio call to Roz Woods – stay strong.

Harry Simm

Secretary

Windellama Garden Club Inc.



# Better Barbeques



At Barbeques Galore you'll discover a whole new world of outdoor entertaining.

A lot of places are selling outdoor products, like Barbeques. The difference is WE can show you how to use them!

We've got a huge range of the latest aluminium, wicker and timber settings to suit both the size and style of your backyard.

**4821 1292 or 4821 4889**

388 Auburn Street, Goulburn [www.barbaquasgalora.com.au](http://www.barbaquasgalora.com.au)

**LARGE RANGE  
GREAT PRICES  
FRIENDLY STAFF  
GREAT SERVICE**

**BARBEQUES  
GALORE**

**BBQBaHar.**



# Windellama Public School News

**Email:** [windellama-p.school@det.nsw.edu.au](mailto:windellama-p.school@det.nsw.edu.au)  
**Website:** [www.windellama-p.schools.nsw.edu.au](http://www.windellama-p.schools.nsw.edu.au)

**Phone:** 4844 5130  
**Fax:** 4844 5265

## WINDELLAMA P&C FIREWORKS AND AUCTION NIGHT FUNDRAISER

A **HUGE** congratulations to the very dedicated P&C and school community for another **FANTASTIC** Auction and Fireworks night. It is always a **FABULOUS** community event. We raised over \$11 000 this year, an **AMAZING** record. We extend our thanks and appreciation to Graham Kinder for his wonderful auctioneering and continued support of our school and we also extend that thanks to all of the businesses who support this event. Foto as always did an exceptional job with the fireworks.



## TREC DISTRICT ATHLETICS

Well done to Montana, Toby, Cooper, Shkeira and Kiara who all did very well when they represented TREC at the District Athletics Carnival.



## GRC PARTNER SCHOOLS DAY

We attended the GRC partner schools day at the Goulburn Regional Conservatorium. We thank Miss A and her team of GRC teaching staff and students from the Sydney Conservatorium of Music for a great day of music education. The day featured lots of interactive and fun music activities.



## COMING UP

### TREC ABORIGINAL CULTURAL DAY AT BREADALBANE PUBLIC SCHOOL

K-6 students will attend an Aboriginal Cultural Day. We will meet with an Aboriginal Elder who will spend the day with us. These days are great to meet up and learn with fellow TREC students.

### COUNTRY WOMEN'S ASSOCIATION AT TARAGO HALL

All students will attend the CWA Country of Study morning at Tarago. **This year's** country is Nepal and students in Years 2 – 6 have been working diligently on a power point presentation.

## REGIONAL CROSS COUNTRY

Congratulations to Montana who again made us proud when she representative TREC and Goulburn/Crookwell PSSA at Regional Cross Country.



# THINKING DAMS? THINK **DIVALL'S**



GET **100%** TAX  
DEDUCTION ON  
YOUR FARM DAM

**RIGHT NOW**



282 CARRICK ROAD, GOULBURN NSW 2580

PHONE: (02) 4829 8200

WEBSITE: [WWW.DIVALLS.COM.AU](http://WWW.DIVALLS.COM.AU)

# WINDELLAMA VOLUNTEER RURAL FIRE BRIGADE

## WINDELLAMA RURAL FIRE BRIGADE

Report all Fires 000  
& Emergencies

Brigade enquiries 4844 5359  
UHF 21

Yass - 6226 3100



RFS website [www.rfs.nsw.gov.au](http://www.rfs.nsw.gov.au)

or Brigade website [www.windellamarfs.com.au](http://www.windellamarfs.com.au)

**Captain – Dave Edworthy 4844 5359**

**Snr. Deputy Captain - Paul Alessi 4844 5149**

### Over the Last Month (or so)

The Windellama Rural Fire Brigade Annual General Meeting was held on 27 May 2017 with Des Kingston (Deputy Group Captain) presiding as Acting President, since Jim Meehan had recently decided to step down as President, after a long period of service, as a Captain, President and firefighter. Paul Alessi provided a short report as he has been Acting Captain for only a few weeks (at short notice). There was one grass fire, and one fire which turned out to be an un-notified burn. Des thanked Paul for stepping into the Acting Captain's role at such short notice.

A number of long-standing Brigade Officer Bearers did not seek re-nomination, and a number of new Office Bearers were duly elected.

Des Kingston congratulated all those elected to Brigade positions (see below), and thanked all those who have stepped down, for their service. The election results were:

Field positions		Other positions	
<b>Captain</b>	Dave Edworthy	<b>Equipment Officer</b>	Doug Gurney
<b>Senior Deputy</b>	Paul Alessi	<b>Assistant Equipment Officer</b>	Mick Heppleston
<b>Deputies</b>	Ashley Armstrong, Wayne Back, Graham Kinder, Brett Roberts, Marten Schutterups, Brendan Shannon, Brett Vilnis	<b>Community Engagement Officer</b> <b>Assistant Community Engagement Officer</b>	Dave Edworthy Will Hargan
<b>Administrative positions</b>		<b>Training Officers</b>	Wayne Back & Graham Kinder
<b>President</b>	Graham Kinder	<b>Health &amp; Safety Officer</b>	Thomas Shannon
<b>Treasurer</b>	Keith Scorrar	<b>Catering Officer</b>	Marlene Carmichael
<b>Secretary</b>	Peter Pokorny	<b>Assistant Catering Officer</b>	Judy Yates
<b>Asst. Secretary</b>	Lisa Porter	<b>Assistant Catering Officer</b>	Katie Reece

Also in attendance were Stuart Martin (Group Captain, Group 8, Southern Tableland Zone), and Ian Kennerley (Operations Officer, Crookwell, Southern Tableland Zone). After the AGM, they addressed the meeting with recollections and lessons learned from the past year, and updated

*(Continued on page 19)*





## **MICK'S MULTI TRADES**

ABN: 90 178 544 738

Multi Skilled Tradesman

Windellama NSW

Lic # MVTC 126573

Mob: 0413 059 587

Email: [micksmultitrades@gmail.com](mailto:micksmultitrades@gmail.com)

Proudly supporting the Windellama community is Mick

A multi skilled tradesman and diesel mechanic by trade

We renovate bathrooms, tiling and floating floors.

We can also build your shed and help you design and convert your shed into a home, installing your water tanks and fencing.

I have always looked after the locals, and turn a hand to any job.

**So shoot me an email or phone anytime, you'll be pleasantly surprised at our down to earth rates.**



# **CJ Solar**

"Quality Systems that last"



**Home, Business or Community Organisations**

**Custom Designed To Meet Your Energy Needs**

- ◆ Stand Alone Systems
- ◆ OnGrid With Battery Backup
- ◆ Grid Connect
- ◆ Clean Energy Council Accredited

**Ph: 4849 4225**

[www.cjsolar.com.au](http://www.cjsolar.com.au)

PREVIOUSLY TRADING AS SUN POWER

LICENSED ELECTRICAL CONTRACTORS (241654C)

the meeting with changes expected in the coming year.

The newly-elected President, Graham acknowledged the long service to the Brigade by Rex Hockey, Jim Meehan, Bev McGaw, and Ellen Sylvester. Radio communications on UHF Channel 21 will change, as Bev will no longer be the Communications Officer. Since it was widely acknowledged that Bev is irreplaceable, it is proposed that the Communications Officer functions should be performed by a roster of Duty Officers. This will be discussed at the next meeting of the Brigade to be held on 24 June 2017. More details to follow on this one.

If you wish to take part in the Windellama Brigade training or be contacted by e-mail regarding the monthly training details visit the Brigade's website and send an on-line contact form. For information on training dates, times and scenarios, check the Brigade website or contact Training Officers Wayne Back 0412 708 072 or Graham Kinder 0429 892 154. [www.windellamarfs.com.au](http://www.windellamarfs.com.au).

Please take care on our roads and see you at the next training and General Meeting. All welcome.

**Next Training; Sat 24 June at 13.00 (1.00 p.m.)** Motor Vehicle Accident Response and Rural Fire Driver Skills

**Next General Meeting Sat 24 June at 16.00 (4.00 p.m.) Please Note the New Meeting Time**

## BUSH FIRE DANGER PERIOD FINISHED ON 31st MARCH 2017

### SOUTHERN TABLELANDS ZONE

#### **Burning-off now permitted with regulations:**

While the fire season has finished and permits are not required for burning off from the 1st April 2017, there are still regulations that must be followed. Fines can apply if regulations are not carried out. IF YOU'RE NOT SURE CONTACT YASS FIRST.

Yass MUST be notified 24 hours before you light the fire, during business hours 9am to 5pm and by 3.30pm on Friday afternoons, phone 6226 3100.

Your immediate neighbours must also be notified.

Notify the Brigade as a courtesy to save time, if smoke is spotted, phone 4844 5359.

**For more information contact one of the Brigade phone numbers above.**

**JPS AUTO**  
 MVRIA licenced vehicle repairer.  
 Licence number 47196

Mobile Repairs and Servicing to  
 most vehicles.  
 Battery-Breakdown Service

Peter Clinch MIAME  
 63 Cathcart Street  
 Goulburn, NSW, 2580

**0412 424 512**  
**jpsauto@iinet.net.au**



**JPS IT SUPPORT**  
 Computer Repairs

Richard Brodie  
 Manager  
**0404 567 535**

richard@jpsitsupport.com.au  
 www.jpsitsupport.com.au

63 Cathcart Street  
 Goulburn NSW 2580  
 Ph: 02 4873 5220  
 Fax: 02 4855 0153



## Our Advertising Charges

Classifieds - Personal  
 (maximum 2 lines)

**FREE**

	Month	Year11 issues)
Small advertisement (business card size)	\$ 6.50	\$ 65.00
Quarter page advertisement	\$12.00	\$120.00
Half page advertisement	\$25.00	\$250.00
Full page advertisement	\$50.00	\$500.00
Double page discount		\$90.00

Inserts - \$40.00 for 400 inserts into hard copies

Typesetting of adverts: \$50

### **PAYMENT:**

**Cheques: payable to Windellama News**

**PO Box 705, Goulburn. 2580**

**Direct Deposit or EFT: IMB Ltd; BSB 641.800;**

**A/c 200045794 with Name & advert as detail**

**\* Unpaid adverts will be cancelled after one month**

**\* All advertising copy must be accompanied with payment**

All advertising enquiries to

Christine Woodcock

# WINDELLAMA PLAYGROUP

at

Windellama Public School

Each Thursday

9.30am – 11.30am

**BYO snacks - tea & coffee supplied**

**Qualified art teacher visiting each fortnight**

**Bring your bubs & toddlers for a fun morning**

**Music, stories, sand-play, free-play, art, craft.**

**FREE!**





## Sifton Bush Elimination and Control Advice

If Sifton Bush has been established in an area for some years, the seed bank exists and there is nothing one can do but follow up clearing of an area every year, before seeds form.

On hillsides where there is little else binding the soil, Sifton Bush has a positive contribution. Leave it there until other grasses and ground cover develop.

To control Sifton bush, EITHER chip, or cut with secateurs, the smaller plants at ground level (at least so that no shoot remains below the cut). Large plants can be cut with a tree lopper or trimming saw; OR, If the ground is soft, pull out the plants (but this disturbs the soil and may enable germination of seed).

There is no 'easy' option if one wants to eliminate and not just control the pest; preference is elimination because control is even harder work as similar effort is needed every year.

If slashing, walk the area (at least before the next seeding), and remove shoots that have been missed; many shoots can be missed because a slasher cannot be set low enough. Without follow-up the plants will continue to grow and become thicker because of the seed bank.

Note: For all larger plants ( $> \frac{1}{2}$ " ) ensure the stem is cut as close to the ground as possible (less than  $\frac{1}{2}$ " ) above the ground otherwise the stem may reshoot.

NSW WeedWise says "Flowering occurs from October to May depending on location." We recommend follow-up on an area should occur before the end of December to ensure no flowering results in seed formation.

For further information about Sifton Bush, Google <http://weeds.dpi.nsw.gov.au/Weeds/Details/253> and for ALL weeds enter "NSW Weedwise" into your search engine and go to [weeds.dpi.nsw.gov.au](http://weeds.dpi.nsw.gov.au).



---

### AN IMPORTANT DATE FOR YOUR DIARY

**Saturday 19 August** will be our next Windellama Landcare Group working bee.

We will meet at the "**Chain of Ponds**" site at **10.00 am** (it's on the right-hand side about 1km along Sandy Point Road, from the corner of Oallen Ford Road) Look for our cars.

Come and join us for a cuppa and a chat. Stay and help us finish some fencing and repairs. Have some fun, meet new people, learn some new things, protect Windellama.

For more info phone Secretary Graham 0429 892 154 or President Kevin 0408773773

All welcome!

# P R O N I C

A G R I

A mobile service for all your rural living  
mechanical repairs

Service & repair of : -

Tractors  
Self propelled machinery  
Sprayers  
Quad bikes  
Air conditioning  
Ride on mowers  
And all general farm machinery

Contact Mathew Nicholls

Tel : 02 4844 5857 Mob 0417 998 938

e-mail : [proniacagri@yahoo.com](mailto:proniacagri@yahoo.com)

abn 28 228 073 983

a/c licence no: L058811

## Booyong Alpacas

2217 Windellama Rd.

Quialigo. NSW. 2580.

Tel.02 4844 7267.

Mob. 0417 658730.

Web. [www.booyong.com.au](http://www.booyong.com.au)

Like us on Facebook

[www.facebook.com/booyongalpacashop](http://www.facebook.com/booyongalpacashop)

Email: [booyongalpacas@optusnet.com.au](mailto:booyongalpacas@optusnet.com.au)



**Breeding Coloured Huacaya Alpacas**

since 1997 with a current herd of 175 Alpacas

**Alpaca Sales & Stud Services**

**On Farm Alpaca Shop**

selling 100% Booyong Alpaca Products  
& Selected Imported Alpaca Garments.

Call us for advice or to visit the farm & view  
our Alpacas & Shop.

Buying or selling house or land?

## JOHNSON & SENDALL

Incorporating Mullens & Stephen J Lamond

SOLICITORS – CONVEYANCERS

For advice on all your legal requirements

Morris Owen ~ Alison Howarth ~ Tim McGrath ~ Carl Henwood

p: 02 4821 1588 f: 02 4821 9850 e: [info@johnsonandsendall.com.au](mailto:info@johnsonandsendall.com.au)

[www.johnsonandsendall.com.au](http://www.johnsonandsendall.com.au)

13 Montague Street Goulburn 2580



Athletics Coach

Personal Trainer

Marina Wenban

Ph: 0439 029 313

Accredited Athletics Australia,

AT&FCA, Fitness Australia

# Windellama Historical Society from Tom Bryant

**EDUCATING THE HORSE.**  
Professor  
**THEODOR LICHTWARK**  
WILL GIVE A  
**Free Lecture**  
AT  
**Windellama on Thursday, the 20th June,**  
**at 8 p.m.**  
CLASS LESSON, corner of Verner and Sloane  
streets, Goulburn, on **MONDAY, the 24th**  
**JUNE, at 7.30 p.m.**

## EDUCATING THE HORSE

Professor Theodor Lichtwark, who has been holding classes in the surrounding districts for the purpose of teaching his system of educating the horse, is again in Goulburn, where, as will be seen by advertisement, he holds a class lesson this evening in Mr Walker's building.

During the professor's stay at Windellama a young unbroken colt was handled before the onlookers by one of his pupils, and in less than two hours this gentleman could do practically anything with his erstwhile lively subject—riding and tumbling about on its back, handling its forelegs, and strolling around the yard with his young pupil following.

This should satisfactorily prove the genuineness of the professor's system, showing as it does that any one is capable of

doing the same as himself.

(Goulburn Herald 24 June 1896 page 2)

\*\*\*\*\*

## THE OLDEST COLONIST

There is now living at Goulburn (N.S.W.), Robert Chipp Thompson, who was born in 1815, and is therefore in his 96th year. He claims to be the oldest living Australian native. He has had an adventurous career, and is still active. A few weeks ago he walked from Windellama to Goulburn, 24 miles. He states that in his early days there was no flour in the country. When he was minding sheep on the Hawkesbury he used to cook a cob of corn. It was called Hawkesbury Duck. He was 17 before he wore boots. Only knee boots were then available, and they were £5 a pair. He was a horse breaker, and while following that occupation had both legs broken, his shoulder fractured, and his ribs stove in.

(Casino and Kyogle and North Coast Advertiser 29 March 1911.)

\*\*\*\*\*

WINDELLIMA. Church Service. Owing to inability of the Rev. Mr Procter to travel, the Jacqua church has been closed for some years back. Arrangements have now been made between that Rev. gentleman and the Rev. W Anderson, whereby the latter will hold service in the said church regularly. I believe it is his intention to hold service in future at eleven a.m. at Windellima and at three p.m. at Jacqua.

A Sunday school is to be started on the 9th inst. at Rose Vale under the superintendence of Mrs Thomas Middleton, that good lady having undertaken the very necessary position of Sunday school teacher to the village. I wish her every success. I believe it is also in contemplation to open a Sunday school at Windellima, but nothing definite has been arrived at yet.

(Goulburn Herald 3 November 1879 page 3)

Tom Bryant 8 June 2017.





# GET THE JOB DONE RIGHT!

**JCF Contractors have the manpower, equipment and experience to complete your custom project to budget, to spec and on time.**

**JCF CAN ASSIST WITH:** Road Works • Shed Sites • Driveways • Site Works • Septics  
• Arenas • Trenching • Demolition • Landscaping • Rural Fencing • Earthmoving  
• House Excavation • Temporary Fencing • Rubbish Removal • Footing & Piers

**JCF EQUIPMENT:** Trucks • Dozers • Rollers • Graders • Bobcats • Tipper  
• Watercarts • Excavators • Gravel Supply

**0428 624 966**

Call Jon for a free assessment of your property  
*Servicing Goulburn & surrounding areas.*



**MANPOWER, EQUIPMENT & EXPERIENCE**



Discarded rubbish is not only unsightly and spoils the beauty of our local area, it can and does injure wildlife and other animals. As wildlife carers we see firsthand the damage that can be caused, which is not only sad, but also frustrating considering it is totally preventable. How we dispose of rubbish can help prevent injuries and death to inquisitive or hungry creatures.

Fishing line and netting left laying around are a major hazard. Likewise fishing hooks, which can be swallowed by unsuspecting creatures causing them much suffering, and usually a slow and painful death. This doesn't just apply to coastal areas, it also happens on inland waterways. For example a Crested Grebe was found entangled in fishing line at Pejar Dam. Thankfully the bird was uninjured, and after being freed was able to be released immediately. Others, like a Long-necked turtle rescued from Wyangala Dam after swallowing a fishing hook, are not so fortunate.

We all use bottles with a plastic seal around the top - how we dispose of this small ring can be the difference between life and tragic death for unwitting wildlife. Before disposal, cut it open so it no longer poses a threat.



*Top: X-ray of Eastern long-necked turtle - arrow showing swallowed fishing hook.*

*Bottom: Brown Snake caught in empty drink can*

Plastic bags, the bane of modern society, are seen along almost every roadside; many end up in waterways entangling turtles and platypus, or wash out to sea causing untold damage and slow death to marine creatures.

Drink cans are deadly traps; snakes are one species that become trapped while exploring the inside of a can. If a snake slithers its head through the opening, it may be unable to get it back out, as its scales do not bend backwards, therefore keeping it pinned at the neck. This Brown Snake was fortunate that it was found, and the can successfully cut off - after a couple of days in care to recover from the trauma, it was released back into the area it was found.

Then there is the orchard netting, often seen as discarded piles about yards or sheds when no longer needed, or loosely draped over fruit trees and veggie gardens to protect plants. Many creatures get tangled up in the netting, suffering constriction,

dehydration and starvation. Never use thin nylon (monofilament) netting, use only the thicker knitted netting, making sure that the holes are small enough so that you can't poke your little finger through. Ideally the netting needs to be tightly woven with a mesh of only 2mm and stretched tight over a frame

Glass from empty bottles broken by time, can cut the feet or mouths of unsuspecting wildlife, when running or grazing. They cannot go to the doctor for stitching, bandaging and antibiotics, so many suffer infections that can be fatal, or are crippled, inhibiting their ability to survive.

*(Continued on page 27)*

## FEES & CHARGES

Tipping Charges Residents Only.  
Small trailer is 1800mm x 1200mm x up to 350mm height.  
All Fees x 2.5 for Non-Residents.

	Fee Basis	Fee
Household Recycling (up to a small trailer)	Per Entry	\$4.00
General Waste: Small quantity (small car boot)	Per Entry	\$10.00
General Waste: Twin cab ute / small trailer (max height 350mm)	Per Entry	\$20.00
General Waste: Twin cab ute / small trailer (max height 450mm)	Per Entry	\$27.00
General Waste: 1 tonne flat top ute (max height 450mm)	Per Entry	\$35.00
General Waste	Per Cubic Metre	\$110.00
Garden Organics: Car/station wagon/dual cab ute/small trailer (max height of 450mm)	Per Entry	\$10.00
Car Bodies	Per Item	\$85.00
Fridge, Freezers, Air Conditioners	Per Item	\$20.00



Sounds depressing? It need not be, if we only spare a thought for the other creatures with which we share our environment, and clean up after ourselves, or after others less responsible.

Should you need advice or help with injured or distressed wildlife, please ring the WIRES Rescue Number 1300 094737. Your call will be logged and directed to our branch electronically, so that we can respond accordingly. As always, our volunteers will be only too happy to assist.

Until next time - take care all,

Kay



WINDELLAMA HISTORICAL SOCIETY Inc.



*Hello Everyone,*

*We have been pretty busy getting our new display area in shape (the*



*Shed). we have a lot to do to get everything ready for the 200<sup>th</sup> anniversary of Windellama*

*Windellama will be 200 years old April 2018 ...Tom has compiled a new book to celebrate this milestone birthday ..... more exciting details to come.*

*Windellama History is preserved in our wonderful museum, with lots to look at and lots to talk about, so come and visit at the next Market Day. We have a selection of history books by local Authors Tom Bryant & Rex Hockey, for sale as well as the ever popular "Wild Windellama" by Carina Clarke.*

*The museum is open on Market Days - every third Sunday of each month, from 9am till 1pm and by arrangement.*

*The Next Meeting will be on Saturday 5<sup>th</sup> August 2017 10am at the Museum*

***NEW MEMBERS and GUESTS ARE ALWAYS WELCOME***

***For any enquiries please contact: Rex Hockey: 48 445147***

***Marcia Tatam: 48 216421***

***Julian Woods: 48 44 5270***

## Adding services to Big READ Bus

Goulburn Mulwaree Council is trialling a new service with the Big READ Bus, our well-loved mobile library van.

Members of Council's Customer Service team will be getting out of the office and onto the Big READ Bus each month to offer services to our regional communities in their own towns.

Along with the normal range of Library services, customer service team members will be able to undertake payments and transactions (cheques and EFTPOS only at this time) as well as lodge service requests. This will allow our community members who may typically have difficulties getting into the Civic Centre in Goulburn to lodge requests.

Craig Johnson, Business Manager Customer Liaison, says the aim is to make life easier for rural communities. "The Big READ Bus initiative has been extremely successful, and we want to build upon this great resource to reach our customers in all corners of the Local Government Area. This trial will give community members a chance to make their payments in their own town, and they will also be able to lodge service requests for jobs and works that they may have difficulty doing otherwise."

The service rollout is part of Council's continuing drive to be 'Easy to do business with.' The trial will begin on Wednesday the 14th of June, and will run for the months of June and July, before being re-evaluated.



## Nerriga Gardeners

On yet another foggy morning we gathered at various places along the road and made our way to Lynley and Gary's bushland hideaway. Since our last visit there have been lots of earth works and there are now 2 terraces for the edible plants to go on with metal hoop frames being reconstructed along them. The browsing and climbing animals make protecting plants an absolute as the possum has made its way on to the terrace in front of the house which is on top of a sheer drop and fenced! Gary has been working hard to get in the footings for the actual house and construct steps and paths into the grounds. There were several clumps of a greenhood orchid with flowers just past their



best. It has been a great year for them with Sue having found clumps on their property too. She has identified 3 or 4 species. Lynley and Gary have an amazing collection of potted plants waiting for permanent homes and many are quite tender ones that they seem to be able to grow such as banana plants ( until the big frost at the end of May but it had survived 3 years and may come back ). Morning tea was enjoyed on arrival and then we basked in the sun on the terrace before clambering around the garden while Lynley took the less mobile down to the new

levelled sites in the car and then on to the creek where a few frogs were calling. Then back to the house for lunch and a natter.

Our next meeting will be at Di's house in Nowra on Thursday 20<sup>th</sup> July and as usual all are welcome. Please bring a plate to share and lets see if we can maintain our unplanned record of everyone bring something different and yummy.

Further info Kay Hamer 48459021 or better [kahamer@activ8.net.au](mailto:kahamer@activ8.net.au)



My phone goes to the answer phone very quickly which means I don't pick up the nuisance calls so please leave a message and I will get back to you or may even interrupt you in the process if I have managed to hear the phone ( have my hearing aids in ) Kay



# ~~The Loaded Dog Hotel~~



Tarago EST 1848

Hoteliers: Nicole & Mark Ryan [www.loadeddoghotel.com](http://www.loadeddoghotel.com) 02 4849 4499  
1 Wallace Street TARAGO NSW 2580 | 02 4849 4499 | [loadeddoghoteltarago@gmail.com](mailto:loadeddoghoteltarago@gmail.com)

## LIVE MUSIC @ THE DOG

July 15th

Jemma Beech

August 19th

Adam Toms

### Social Darts

7:30pm every  
Wednesday fortnight  
come  
alone or  
bring a  
team.



### Bingo @ The Dog

11am on 1st Wednesday  
of each month.

Supporting  
the Tarago  
Mens Shed



### State of Origin

Game 3  
THE DECIDER  
July 12th



# The Dog Bistro is open 7 days for lunch and dinner

Sunday to Wednesday 6pm - 8pm

Thursdays (Nicole's Fish'n'chips) 6pm - 8pm

Friday and Saturday 6pm - 8:30pm

Lunches 7 days 12noon - 2pm

## CHURCH INFO

### Catholic Church Services

Parish Priest: Fr. Dermot McDermott

Assistant: Fr. Assin

Deacon: Chris Van Gessel

Presbytery & Parish Office  
Phone 4821 1022

\*\*\*\*\*

Sunday Mass will be at 8am on the 2nd & 4th  
Sunday at St. Patrick's **Marulan**.

Mass Times in **Goulburn** are:

Saturday Vigil Mass:

5pm at St. Peter & St. Paul's

Sunday: 7am. at Our Lady of Fatima,  
Nth. Goulburn

Sunday: 10am. at St. Peter & St. Paul's

---

### **St. Joseph's Church, Tarago**

Enquiries: 4821 1022



### CHURCH SERVICES

#### **St Bartholomew's Windellama**

All Services now at St. Barts

9th July

23rd July

Services now start at 10.30 am

Reverend Peter Bertram

### **Fees for Hire of Hall or Supper Room at Windellama Hall**

<b>*HALL ALL DAY</b>	\$200
<b>DAY 4hrs or less</b>	\$100
<b>EVENING/NIGHT**</b>	\$200

\*Includes Supper Room & Kitchen

\*\* \$2 per hour for heating

#### **SUPPER ROOM** (Includes Kitchen)

<b>ALL DAY</b>	\$80
<b>DAY 4hrs or less</b>	\$40
<b>EVENING/ NIGHT</b>	\$100

# Use of the premises prior to your booked  
function will incur a surcharge of  
Supper Room Fee

**To Book please ring W. P. A. Secretary,  
Leanne Lourigan on 4844 5545**

---

### **St. Andrews (Anglican) - Tarago**

2nd Sunday 9am

St. John's - Lake Bathurst

4th Sunday 9am

---

### **NERRIGA**

#### **ANGLICAN CHURCH SERVICES**

**Held at Nerriga Church**

**2nd Sunday each month at 2pm**

**(Except Easter & Christmas)**

**All Welcome**



# Countrywide Shower Screens



## Shower Screens

• Frameless • Semi-framed • Framed

## Mirrors

• Bevelled • Polished

**Mick Greenwood**  
**0448 494 220**

Fax: (02) 4849 4220

E: [countrywideshowerscreens@bigpond.com](mailto:countrywideshowerscreens@bigpond.com)

**Free Measure and Quote**

# Lowline Cattle

A small beefy, Angus derived breed – quite & easy to handle.

## Why Lowlines?

### MORE BEEF TO THE HECTARE

- ✓ smaller size means easier handling ✓ higher stocking rates
- ✓ low birth-weights ✓ early maturity ✓ compact bodies
- ✓ excellent feed efficiency ✓ less stress on fencing ✓ less soil compaction



Great for first time cattle owners of any age and gender

## Windellama Downs

*Producing quality, Australian breed cattle & sheep  
suitable for any size rural holding*

## Stock for sale

Commercial or registered stud stock

Mob: 0416 047 488 Ph: 4844 5175

Email: [windellamadowns@iinet.net.au](mailto:windellamadowns@iinet.net.au)

# RON WENBAN

## \*\* LOCAL ELECTRICIAN \*\*

\*\*

Rural \* Domestic \* Commercial

**PH: 0428 445 259**

Email: [ronwenban@skymesh.com.au](mailto:ronwenban@skymesh.com.au)

NSW LIC. #174303C

ACT LIC. #2008568



## Southern Districts Piano Service

Pianos • Pianolas • Tuning • Repairs  
Re-polishing • Removals

*Graham Price*

**02 4844 5329**

**Industrial • Commercial • Rural • Domestic**  
**Ph 4844 7088 INSTALLATIONS 0418 234 289**

# ALLARD

**ELECTRICAL CONTRACTING SERVICES**

**SOLAR UTILITIES & ENERGY SERVICES**

**GAS-OIL COMBUSTION SERVICES**

[stevenallard@bigpond.com](mailto:stevenallard@bigpond.com)

## ELECTRICAL LICENCES:

NSW Lic.No 198855C

NSW Lic.No 498875S

ACT Lic.No 2009576

QLD Lic.No C13290

## ACCREDITATIONS

AUS C.E.C. Design & Install Grid Connect  
& Stand Alone Solar Systems #A3632173



# Classified Advertisements

***All personal classifieds are FREE & also included in the Tarago Times***  
***We run your advert until you let us know when you have sold it or gained it***

## GENERAL FOR SALE

**Ashford Traditional Spinning Wheel** with spare bobbins plus lazy kate, good condition \$100 Irene 4844 5214 Virginia Boyd 4822 8004

**Firewood** - Split, seasoned. Ute load - approx one tonne. Local delivery - \$150 per load. Ring Greg- 4844 5157.

**AIROMIST NEBULISER-** Airomist Therapy System. For medications such as Ventolin, Asmol, Bricanyl, Atrovent & many other medications. \$100.00 Phone: 48445125

**Wooden T.V. Console** in VGC. Size W=186cm, H=147cm, D=59cm. Contains a glass cabinet each side, 2 drawers, DVD & T.V. Area. \$250.00 or O.N.A. Details 48447061.

**Simpson 5.5kg top load washing machine** in good working order.\$100 ono. Grahame 0403499068

**High grade quality woollen yarn rugs** cream and deep red both matching in great condition small 150 x 239 large rug 250 x 350. \$400 ono. Call Elisha 0403542471

**Teak entertainment unit**, with two glass door display. 6x4 foot. \$75.00 ONO.

**Double bunks**, Metal, with ladder, new innerspring mattresses. \$125 ONO

**Two wooden bed side tables** with cane draws.\$50 for two. Ph. 4849 4480

1 x **King Single bed** \$200;1 x **Single bed** \$150;1 x **Single bed** \$100;**Dressing table/ chest of drawers** (8) \$150; 1 x **Glass TV table** \$150; 1 x **Glass coffee table** \$50 Ph 0411 421 416

**Lounges** - 1x3, 1x2 + ottoman - yellow fabric, Matching chair in navy blue. All GC. Offers over \$500 considered. 4849 4222

**Desk** - large timber , 2xdraws/storage under. Leather inlay + matching 2drawers file cab. Ergo office chair. All VGC. \$400 ONO 4849 4222

**Firewood.** \$150 per load. Ph 4849 4520 for delivery

**Firewood.** 2 tonne truck load \$430, ½ truck load \$250. Ph 0401 241 646

**2nd hand container** for sale. \$3000 not/neg. In Goulburn area. Buyer responsible for all transport costs.0435798941

## ANIMAL RELATED FOR SALE

**Parrot Cage** on stand, good cond. \$150 ONO. Ph 0429 006 745

**Saddles**, good condition, \$350 & \$200. ONO. Riding helmets \$30 and \$20. Also other gear: bridles, leather straps, etc. Ph 0434 286311.

**Miniature Shetland Gig** well balanced, hardly used, some harness, pneumatic tyres, lightweight \$730 ono Ph 62301774 or 0417749064

## ANIMALS FOR SALE

**Alpacas** - lots of different colours & ages. From \$250 each Phone Jacki 0428 298 157

**Horse part Arabian**, 3 yrs old, regd, 14.2 hh, chestnut mare. \$3,000 Ph 0429 461 490

**Alpaca Wethers** Variety of Colours, ages 12 months – 3 years.Halter Trained Wethered, Needled & Shorn. \$400.00 each. Phone 4844 7267. Faye & Keith. Quialigo.

**15 milking goats.** A mixture of male and female. Friendly and well behaved. Price negotiable depending on number purchased. Ring Julia 42761489.

**One six month old pig** for sale - approx. cost \$150. Please call Julia on 4276 1489

## AGISTMENT

**Horse Agistment** available at 41 Burrabinga Road Tarago. Please phone 0429 461 490 for enquires

## CARS, BIKES, TRAILERS, etc. FOR SALE

**Nissan Pathfinder**, very good condition, new tyres - excellent vehicle to drive and well maintained - V6, 250,000 Ks, Recent full airconditioner service - Compliance plate late 1999, \$6,000. Phone 48459147.

**1994 Ford Laser Hatch** In good condition Registered to 15th September 2017 Just had major LOG BOOK SERVICE Goulburn Mazda \$ 3,500.00Phone Noel 48445407

**20 inch 7 spoke mag wheels** in great condition near new tyres 95% tread on them. Ideal for Commodores. \$800 ONO call Richard on 0403542471

**2006 Yamaha XT 250.** VG condition, never dropped. 26,000 km. Elderly owner. New battery, unregistered. \$1800 48445244

## Classified Advertisements cont

**1994 Ford Laser Hatch** reg till 15 Sept 2017, good condition 105,000 klms, just had log book service \$3,500 ph 4844 5407.

**Camper Trailer** Queen sized bed with large room. Plenty storage room. Comes with zipon canopy/shelter. Easy to erect/store/transport. \$3500 ono Ph 62301774 or 0417749064

---

### RURAL RELATED FOR SALE

---

**Free standing drill press** single phase power and adjustable speed. Comes with vice \$300 ono call Richard 0403542471

**Lucerne Hay** Prime soft green small bales \$15 8 x 3 x 3 bakes of lucerne or beardless wheaten available phone 0428493194

**Stanbury Electrical 75 amp battery charger** - new condition, used twice only for Solar batteries - \$1200. Pho 48459147 after 6P.M.

**Gallagher Lightning Diverter** for electric fence energiser protection. New & unused - \$30 Ph: 4844 5843

**Sherwood hydraulic log splitter** 3 point linkage, horizontal and vertical operation. \$3,500 ONO Ring Grahame 0403499068

---

### WANTED

---

**I'm after a horse breaker**, 4 year old Arabian cross in the windellama area. Please phone Teressa 0421996795.

**Info on star picket straightening service.** Call Margaret 0459142230 / 48445566

**Knitting wool** for volunteer knitters for charity. Any leftover wool, any ply, gratefully accepted. Ph Denise 4844 5087

**Instantaneous LPG** Gas Hot Water system 16-20 litres per minute flow rate, working or not. Ph Gary or Sharon on 4844 5980

**Galvanized** farm gates 2 of 3.6 meters wide Galvanized C purlins 100mm / 150mm or 200mm 3metrs to 6 meters long  
ph Gary or Sharon 4844 5980

**VT Commodore 1997**—2000 5 litre V8 any condition running or not ph Michael on 0413146140

**Horse agistment** for mini mare from November to May to avoid coastal itch. Please call Tanya 4456 5589

---

### SERVICES

---

#### Belinda's pet minding

Why stress your pets out by putting them in Kennels or boarding and saving on having to get them vaccinated to put them in boarding.

I will come to you . Leaving your animals in their own homes. I have Vet Nurse experience of 10yrs .

I have a miniature pony stud and also breed and show guinea pigs. I will feed Horses , Dogs, Cats, Goats, Sheep, Chickens Ducks,. Medicate animals daily if needed .

Servicing Windellama , Bungonia, Quialigo and Goulburn.

Contact Belinda on 48447168 or 0497179799

#### Cleaning

Need your home cleaned, we can do windows, refresh carpet cleaning, mattress cleaning plus loads more, or help to declutter your home.

Call Tracey on 48445935 or 0407508060

---

### LAND FOR SALE

---

35.5 acres bush block, 3 bedroom house, out buildings, Creek and dam, Oallen Ford Rd Windellama. Please call 0427 5560 69

# COMMUNITY INFORMATION

## Windellama Progress Association

Gary Lourigan (President) 4844 5545  
Leanne Lourigan (Secretary) 4844 5545

## Windellama Rural Fire Brigade

Dave Edworthy Captain) 4844 5359  
Graham Kinder (President) 0429 892 154  
Peter Pokorny (Secretary) 4844 5759

## Windellama Field Day Committee

Co-ordinator Gary Lourigan 4844 5545  
Secretary Leanne Lourigan 4844 5545

## Windellama News

Christine Woodcock (Secretary) 4844 7275  
Gayle Stanton (Editor) 4844 5156

## Windellama Garden Cub Inc.

Harry Simm (Secretary) 4844 7061  
Sharon King (Treasurer) 4844 5980  
Kevin Muffet (President) 4844 7143

## Windellama Hall Country Markets

Lloyd Turner 4844 5214

## Windellama Historical Society

Rex Hockey (President) 4844 5147  
Julian Woods (Secretary) 4844 5270

## Windellama Landcare

Kevin Stewart (President) 0439471714  
Graham Kinder (Secretary) 0429892154  
Jade Kinder (Assistant Secretary) 0449713585

## Windellama CFR

Kevin Muffet 4844 7143

## Windellama School P&C

Shelly Andrews (President) 4844 5630

## Willow Glen Gardeners

Warren Yates 4844 5350

## Wires (wildlife rescue)

Southern Tablelands WIRES 1300 094737

## Justice of the Peace

Linda Shannon 0490041167  
Geoff Burns 4849 4330

## Nerriga PSA

Helen Rolland (President) 4845 9115

## FOR ALL EMERGENCIES eg. FIRES / ACCIDENTS PHONE 000

For Mobile users & Landlines



## Important Phone Numbers

### Rural Fire Brigades



Windellama	Dave Edworthy	4844 5359
Tarago	Warren Seymour	0419 665 393
Taylors Creek	Dave Elward	4849 4240
Mt Fairy/Boro	Brett Daniel	0429964079
Bungonia	Terry Lewis	0408 223 380
Gundary	Tony Kent	0437298200
Nerriga	John Rolfe	4845 9160

Bushfire Information 1800 NSW RFS  
or 1800 679 737

[www.windellamarfs.com.au](http://www.windellamarfs.com.au) or [www.rfs.nsw.gov.au](http://www.rfs.nsw.gov.au)

### **WINDELLAMA PH: 4844 5359 or CHANNEL 21**



### AMBULANCE

**000**

Ambulance Booking 13 12 33  
Goulburn Ambo Station 4827 0444

### Windellama SES

**132 500**

Kevin Muffet 4844 7143  
Poison Info. Service 13 11 26  
Goulburn Base Hospital 4827 3111

### Police

Tarago Station -  
Snr. Constable Gary Handseker 4849 4411  
Goulburn 4824 0799

### Other

Goulburn Railway Station 4828 5816  
Train info & bookings 13 22 32  
[www.countrylink.info](http://www.countrylink.info)  
Country Energy - interruptions 13 20 80  
Lifeline 13 11 14  
Kids Helpline 1800 551 800



# July 2017

- 1Mon	Tue	Wed	Thu	Fri	Sat	Sun
					1 <b>Tarago &amp; District Men's Shed</b> 10 am-3 pm	2
3	4	5	6 <b>Tarago &amp; District Men's Shed</b> 10 am-3 pm	7	8 <b>Tarago &amp; District Men's Shed</b> 10 am-3 pm	9 <b>St Bart's Service Progress AGM 11.00</b>
10 <b>SES Training</b>	11 <b>Craft Afternoon</b>	12	13 <b>Tarago &amp; District Men's Shed</b> 10 am-3 pm	14	15 <b>Tarago &amp; District Men's Shed</b> 10 am-3 pm	16 <b>NPSA Meeting at 3.00pm</b> <b>Windellama Markets 9.00-1.00pm</b>
17 <b>SES Training</b>	18 <b>Craft Afternoon</b>	19	20 <b>Tarago &amp; District Men's Shed</b> 10 am-3 pm	21	22 <b>RFS Meeting &amp; Training Tarago &amp; District Men's Shed</b> 10 am-3 pm SES	23 <b>St Bart's Service</b>
24	25 <b>Craft Afternoon</b>	26	27 <b>Tarago &amp; District Men's Shed</b> 10 am-3 pm	28	29 <b>Tarago &amp; District Men's Shed</b> 10 am-3 pm	30
31						